

L'azienda

Company

Siamo sul mercato dal 1963 e vantiamo una lunga esperienza nel settore.

Disponiamo di una vasta gamma di accessori per macchine utensili di elevato standard qualitativo.

La disponibilità di magazzino ci distingue per la rapidità nelle consegne. Massimo impegno sia sotto il profilo tecnico che commerciale per soddisfare puntualmente le richieste della clientela. Oltre agli articoli standard siamo in grado di produrre mandrini e codolispéciali su richiesta della clientela.

We have been on the market since 1963 and have along experience in the sector.

We have a wide high-quality range of accessories for tool machines.

The availability of stock allows us for the speed of deliveries.

Best diligence both under technical and commercial profile in order to satisfy promptly the requests of our Customers.

In addition to the standard items we can produce special adapters and pull-studs custom-made.



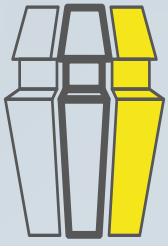

INDICE

PAGINA

7	01. DIN 69871
23	02. DIN 2080
26	Mandrini per transfer <i>Chucks for transfer</i>
37	03. MAS / BT
49	04. HSK DIN 69893
59	05. Mandrini a calettamento termico <i>Shrink fit toolholders</i>
65	06. Mandrini poligonali capto ISO 26623-1 <i>Polygonal taper toolholders ISO 26623-1</i>
73	07. Cono morse <i>Morse taper</i>
79	08. Portapinze cilindrici <i>Straight shank tooling</i>
83	09. Accessori / Ricambi <i>Spare parts</i>
84	Pinze ER DIN 6499 <i>ER collets DIN 6499</i>
94	Pinze EOC DIN 6388 <i>EOC collets DIN 6388</i>
95	Pinze a tenuta <i>Sealed collets</i>
106	Pinze cilindriche <i>Cylindrical collets</i>
107	Pinze grifo <i>Grifo collets</i>
108	Pinze ER per maschi <i>ER tapping collets</i>
111	Codoli <i>Pull studs</i>
117	Ghiere <i>nuts</i>
120	Chiavi <i>Wrench</i>
123	Accessori per portafrese <i>Milling holders spare parts</i>
127	Smontaconi <i>Assembly supports</i>
128	<i>Condizioni di vendita</i> <i>Sales conditions</i>



Brusa & C.
Tooling s.r.l

DIN 69871

Brusa & C. S.r.l.

01

p.7

DIN 69871

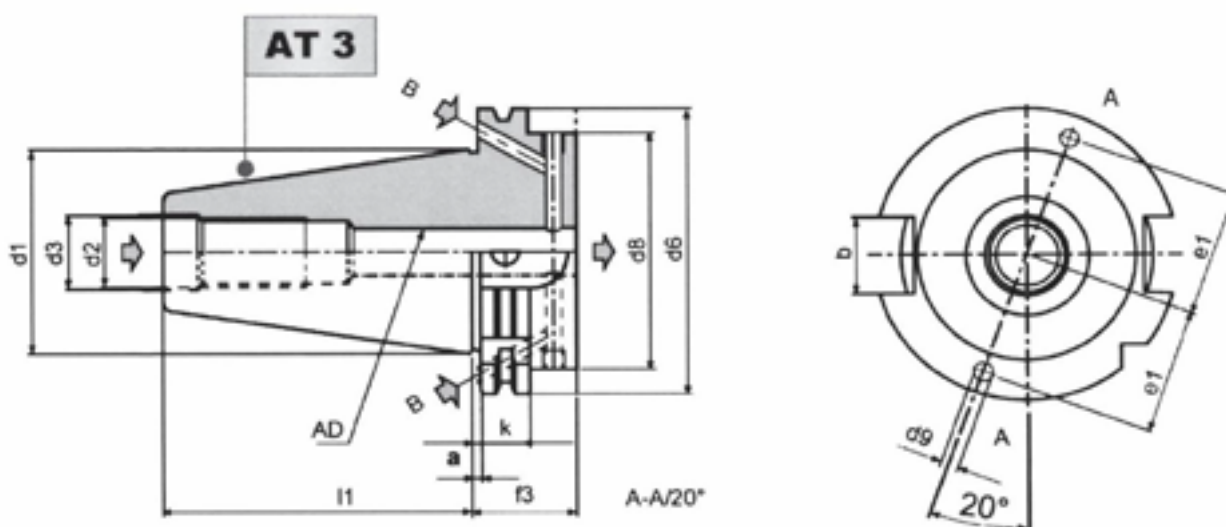

Cono Taper	d1	d2	d3	d8	d6	e1	l1	a	k	f3	b
ISO 30	31,75	M12	13	45	50	21	47,8	3,2	15,9	35	16,1
ISO 40	44,45	M16	17	50	63,55	27	68,4	3,2	15,9	35	16,1
ISO 50	69,85	M24	25	80	97,50	42	101,75	3,2	15,9	35	25,7

Forma AD

Il lubrificante passa dal centro del mandrino.
The coolant through the center of the toolholders.

Forma AD + B

Il lubrificante passa dai fori sulla flangia.
 Tutti i mandrini vengono forniti con grani di chiusura.
The coolant through V-flange bores. All chucks are supplied with closure screws.

Bilanciatura *Balancing*

Mandrini prebilanciati in fase di costruzione.
Chucks pre-balanced under construction

ISO30 Rpm 20000

ISO40 Rpm 20000

ISO50 Rpm 10000



Mandrini portapinze ER ER collet chucks

Articolo article	Attacco adapter	H	C	Pinza collect	Capacità capacity	Note
10/30ER25	ISO 30 (A)	63	42	ER 25	1-16	
10/30ER32	ISO 30 (A)	63	50	ER 32	2-20	
10/302ER32	ISO 30 (A)	100	50	ER 32	2-20	
10/302ER40	ISO 30 (A)	70	63	ER 40	3-30	
10/303ER40	ISO 30 (A)	100	63	ER 40	3-30	
10/301ER40	ISO 30 (A)	120	63	ER 40	3-30	
10/401BER16	ISO 40 (AD+B)	63	32	ER 16	1-10	
10/402BER16	ISO 40 (AD+B)	120	32	ER 16	1-10	
10/401BER20	ISO 40 (AD+B)	70	35	ER 20	1-13	
10/402BER20	ISO 40 (AD+B)	100	35	ER 20	1-13	
10/401BER25	ISO 40 (AD-B)	70	42	ER 25	1-16	
10/402BER25	ISO 40 (AD-B)	100	42	ER 25	1-16	
10/404BER25	ISO 40 (AD-B)	130	42	ER 25	1-16	
10/406BER25	ISO 40 (AD-B)	160	42	ER 25	1-16	
10/405ER32	ISO 40 corto/short (A)	50	50	ER 32	2-20	
10/401BER32	ISO40 Standard (AD+B)	70	50	ER 32	2-20	
10/402BER32	ISO 40 (AD+B)	100	50	ER 32	2-20	
10/406BER32	ISO 40 (AD+B)	120	50	ER 32	2-20	
10/407BER32	ISO 40 (AD+B)	160	50	ER 32	2-20	
10/404ER32	ISO 40 (A)	200	50	ER 32	2-20	



DIN 69871

Mandrini portapinze ER ER collet chucks



Articolo <i>article</i>	Attacco <i>adapter</i>	H	C	Pinza <i>collect</i>	Capacità <i>capacity</i>	Note
10/404ER40	ISO 40 corto/short (A)	50	63	ER 40	3-30	
10/401ER40	ISO 40 (AD+B)	75	63	ER 40	3-30	
10/403BER40	ISO 40 (AD+B)	100	63	ER 40	3-30	
10/402BER40	ISO 40 (AD+B)	120	63	ER 40	3-30	
10/407BER40	ISO 40 (AD+B)	160	63	ER 40	3-30	
10/408BER40	ISO 40 (AD+B)	200	63	ER 40	3-30	
10/501BER25	ISO 50 (AD+B)	100	42	ER 25	1-16	
10/501BER32	ISO 50 (AD+B)	70	50	ER 32	2-20	
10/503BER32	ISO 50 (AD+B)	100	50	ER 32	2-20	
10/502BER32	ISO 50 (AD+B)	120	50	ER 32	2-20	
10/504BER32	ISO 50 (AD+B)	160	50	ER 32	2-20	
10/501BER40	ISO 50 (AD+B)	80	63	ER 40	3-30	
10/503BER40	ISO 50 (AD+B)	100	63	ER 40	3-30	
10/502BER40	ISO 50 (AD+B)	160	63	ER 40	3-30	



Su richiesta si costruiscono altre misure
On request we produce also other measures

Su richiesta ghiera bilanciate per alta velocità
on request balanced er nut for high speed

DIN 69871

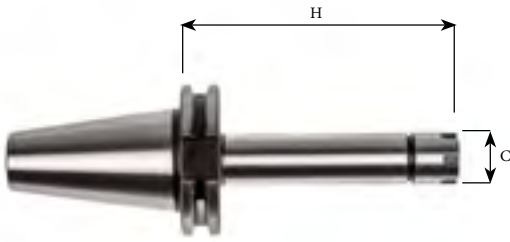

Mandrini portapinze ER tipo slim con ghiera mini ER collet chucks slim type with mini nut

Articolo article	Attacco adapter	H	C	Pinza collet	Capacità capacity	Note
10/401BER11M	ISO 40 (AD+B)	100	16	ER 11	1-7	
10/402BER11M	ISO 40 (AD+B)	120	16	ER 11	1-7	
10/409BER11M	ISO 40 (AD+B)	160	16	ER 11	1-7	
10/401BER16M	ISO 40 (AD+B)	100	22	ER 16	1-10	
10/402BER16M	ISO 40 (AD+B)	120	22	ER 16	1-10	
10/409BER16M	ISO 40 (AD+B)	160	22	ER 16	1-10	
10/401BER20M	ISO 40 (AD+B)	100	28	ER 20	1-13	
10/402BER20M	ISO 40 (AD+B)	120	28	ER 20	1-13	
10/401BER25M	ISO 40 (AD+B)	70	35	ER 25	1-16	
10/402BER25M	ISO 40 (AD+B)	100	35	ER 25	1-16	
10/403BER25M	ISO 40 (AD+B)	120	35	ER 25	1-16	



Mandrini a doppio contatto double contact chuck

Articolo article	Attacco adapter	H	C	Pinza collet	Note
10/40/DER32	ISO 40 DIN69871/AD+B	70	50	ER32	

Su richiesta si costruiscono in tutte le misure e in tutta la gamma
On request we produce them also in others measures and in a complete range of toolholders



DIN 69871 / A

Mandrini portapinze grifo *Grifo collet chucks*



Articolo <i>article</i>	Attacco <i>adapter</i>	H	C	Pinza <i>collect</i>	Capacità <i>capacity</i>	Note
10/407GRIFO	ISO 40	63	62	ART.700	3-20	
10/408GRIFO	ISO 40	79	82	ART.800	6-32	
10/507GRIFO	ISO 50	69	62	ART.700	3-20	
10/508GRIFO	ISO 50	69	82	ART.800	6-32	



Articoli disponibili solo fino ad esaurimento scorte
Available only until run out of stock



DIN 69871 / A

Mandrini a forte serraggio Milling chuck

Articolo article	Attacco adapter	H	D	C	Pinza collect	Capacità capacity	Note
10/40/20FS	ISO 40	95	20	60	100/20	3-18	
10/40/25FS	ISO 40	105	25	60	100/25	3-22	
10/40/32FS	ISO 40	105	32	73	100/32	3-28	
10/50/20FS	ISO 50	95	20	70	100/20	3-18	
10/50/32FS	ISO 50	120	32	73	100/32	3-28	

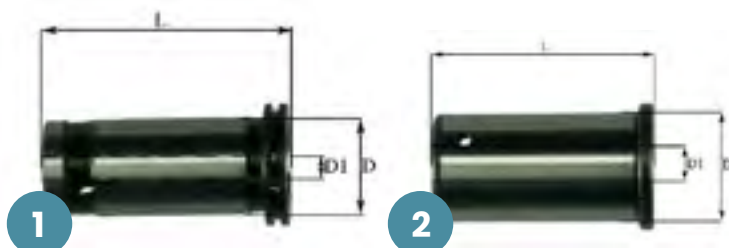

Pinze cilindriche Cylindrical collets

Articolo article	D	DI	L	Note
100/20	20	3-19	50	
100/25	25	3-22	58	
100/32	32	3-30	68	

A tenuta/Sealed:

100/20T	20	3-16	50	
100/25T	25	3-20	58	
100/32T	32	4-26	68	



Disponibili anche con misure decimali e in pollici
Available also with decimal and inch measurements

DIN 69871

Kit mandrini forte serraggio compl. di chiave *Kit milling chuck compl.with key*



Articolo <i>article</i>	Attacco <i>adapter</i>	Pinza <i>collect</i>	Pinze nel kit <i>collet size on the kit</i>	Note
10/KIT40/20FS	ISO 40 DIAM. 20	100/20 Nr. 10 pz.	3-4-5-6-8-10-12-14-16-18	
10/KIT40/32FS	ISO 40 DIAM. 32	100/32 Nr. 12 pz.	4-5-6-8-10-12-14-16-18-20-25-28	



Mandrini attacco weldon Weldon milling holders

Articolo article	Attacco adapter	D	H	C	Note
10/40WE06	ISO 40	6	50	25	
10/40WE08	ISO 40	8	50	28	
10/40WE10	ISO 40	10	50	35	
10/40WE12	ISO 40	12	50	42	
10/40WE14	ISO 40	14	65	44	
10/40WE16	ISO 40	16	65	48	
10/40WE18	ISO 40	18	65	50	
10/40WE20	ISO 40	20	65	52	
10/40WE25	ISO 40	25	100	65	
10/40WE32	ISO 40	32	100	72	
10/40WE40	ISO 40	40	120	80	
10/50WE06	ISO 50	6	63	25	
10/50WE08	ISO 50	8	63	28	
10/50WE10	ISO 50	10	63	35	
10/50WE12	ISO 50	12	63	42	
10/50WE14	ISO 50	14	63	44	
10/50WE16	ISO 50	16	63	48	
10/50WE20	ISO 50	20	63	52	
10/50WE25	ISO 50	25	80	65	
10/50WE32	ISO 50	32	100	72	
10/50WE40	ISO 50	40	120	90	
10/50WE50	ISO 50	50	120	100	

DIN 69871 / A

Mandrini portafrese fissi Shell milling holders

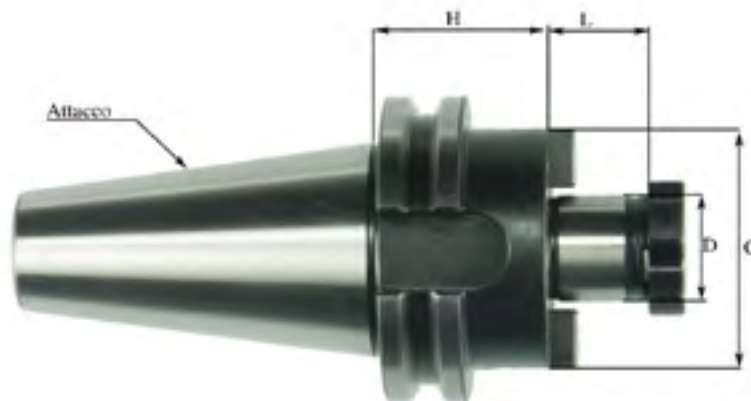

Articolo article	Attacco adapter	D	C	L	H	Note
10/40F16	ISO 40	16	35	17	35	
10/40F22	ISO 40	22	50	19	35	
10/40F27	ISO 40	27	50	21	58	
10/40F32	ISO 40	32	50	24	66	
10/40F40	ISO 40	40	60	27	80	
10/50F16	ISO 50	16	35	17	38	
10/50F22	ISO 50	22	35	19	48	
10/50F27	ISO 50	27	35	21	58	
10/50F32	ISO 50	32	55	24	78	
10/50F40	ISO 50	40	52	27	88	



Prolunghe per P / Frese
Extentions for milling chucks

p.126
p.126



Mandrini portafrese combinati Trascinamento frontale e chiavetta *Combined shell milling holders Frontal dragging and key*

Articolo article	Attacco adapter	D	C	H	L	L1	Note
10/40C16	ISO 40	16	32	55	17	27	
10/40C22	ISO 40	22	40	55	19	31	
10/40C27	ISO 40	27	48	55	21	33	
10/40C32	ISO 40	32	58	60	24	38	
10/40C40	ISO 40	40	70	68	26	40	
10/50C16	ISO 50	16	32	55	17	27	
10/50C22	ISO 50	22	40	55	19	31	
10/50C27	ISO 50	27	48	55	21	33	
10/50C32	ISO 50	32	58	55	24	38	
10/50C40	ISO 50	40	70	55	27	41	

DIN 69871 / A

Riduzioni cono morse per frese *Morse taper adaptor for mills*

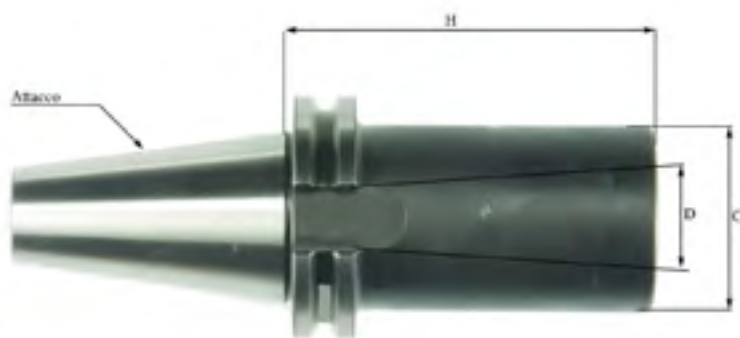

Articolo article	Attacco adapter	H	C	D	Note
10/40CM2F	ISO 40	50	32	CM 2	
10/40CM3F	ISO 40	70	40	CM 3	
10/40CM4F	ISO 40	95	48	CM 4	
10/50CM2F	ISO 50	60	32	CM 2	
10/50CM3F	ISO 50	65	40	CM 3	
10/50CM4F	ISO 50	95	48	CM 4	
10/50CM5F	ISO 50	120	63	CM 5	

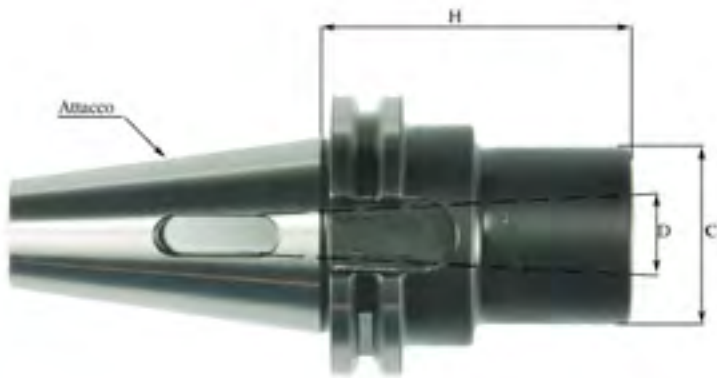

Riduzioni cono morse per punte

Morse taper adaptor for drills

Articolo article	Attacco adapter	H	C	D	Note
10/40CM1P	ISO 40	50	25	CM 1	
10/40CM2P	ISO 40	50	32	CM 2	
10/40CM3P	ISO 40	70	40	CM 3	
10/40CM4P	ISO 40	95	48	CM 4	
10/50CM2P	ISO 50	60	32	CM 2	
10/50CM3P	ISO 50	65	40	CM 3	
10/50CM4P	ISO 50	95	48	CM 4	
10/50CM5P	ISO 50	105	63	CM 5	

DIN 69871 / A

Attacchi mandrini portapunte Drill chucks arbors



Articolo article	Attacco adapter	H	B	Note
10/40B12	ISO 40	40	B 12	
10/40B16	ISO 40	40	B 16	
10/40B18	ISO 40	40	B 18	
10/50B16	ISO 50	40	B 16	
10/50B18	ISO 50	40	B 18	

Articolo article	Attacco adapter	Capacità capacity
35UP/08/B12	B 12	0-8
35UP/10/B12	B 12	0-10
35UP/10/B16	B 16	0-10
35UP/13/B16	B 16	1-13
35UP/16/B16	B 16	3-16
35UP/16/B18	B 18	3-16



**Mandr. autoserranti serie ultra
precisa** *Ultra-precise keyless
drill chucks*

Articolo article	Attacco adapter	Capacità capacity
35ST/08/B12	B 12	0-8
35ST/10/B12	B 12	0-10
35ST/13/B16	B 16	1-13
35ST/16/B16	B 16	3-16
35ST/16/B18	B 18	3-16



**Mandr. autoserranti serie
standard** *Standard keyless
drill chucks*





Brusa & C.
Tooling s.r.l

DIN 2080

Brusa & C. S.r.l.

02

DIN 2080

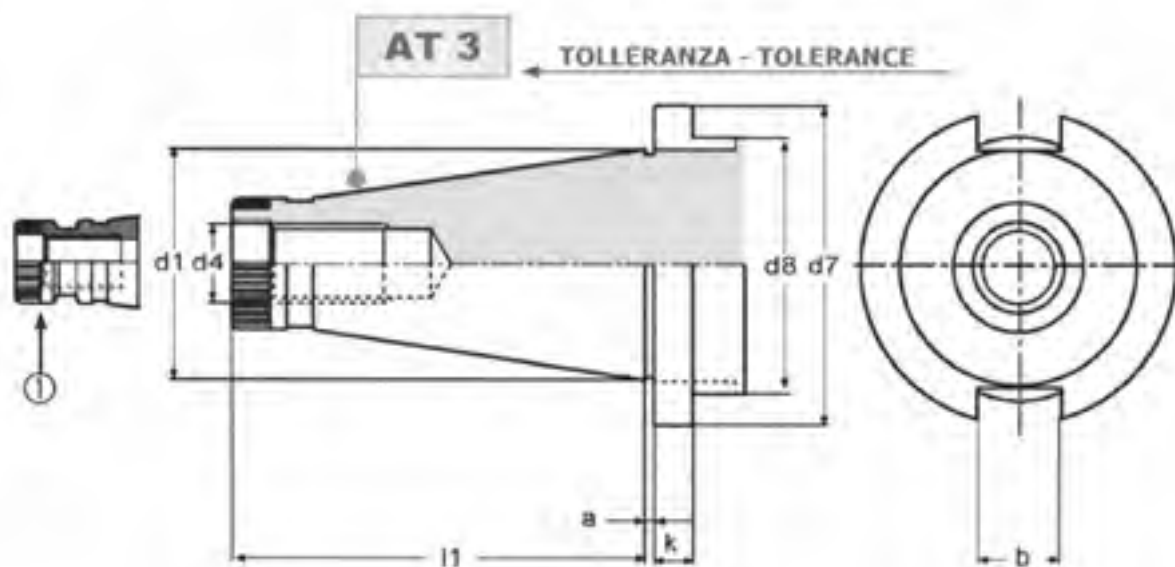

Cono taper	d1	a	b	d4	d7	l1	k	d8
ISO 30	31,75	1,6	16,1	M 12	50	68,4	8	36
ISO 40	44,45	1,6	16,1	M 16	63	93,4	10	50
ISO 50	69,85	3,2	25,7	M 24	97,5	126,8	12	78



Mandrini portapinze ER ER collet chucks

Articolo article	Attacco adapter	H	C	Pinza collect	Capacità capacity	Note
20/30ER16	ISO 30	50	28	ER 16	1-10	
20/30ER25	ISO 30	35	42	ER 25	1-16	
20/30ER32	ISO 30	55	50	ER 32	2-20	
20/301ER32	ISO 30	65	50	ER 32	2-20	
20/303ER32	ISO 30	80	50	ER 32	2-20	
20/304ER32	ISO 30	90	50	ER 32	2-20	
20/305ER32	ISO 30	100	50	ER 32	2-20	
20/306ER32	ISO 30	120	50	ER 32	2-20	
20/307ER32	ISO 30	130	50	ER 32	2-20	
20/301ER40	ISO 30	55	63	ER 40	3-30	
20/30ER40	ISO 30	65	63	ER 40	3-30	
20/302ER40	ISO 30	80	63	ER 40	3-30	
20/303ER40	ISO 30	100	63	ER 40	3-30	
20/304ER40	ISO 30	120	63	ER 40	3-30	
20/40ER16	ISO 40	63	28	ER 16	1-10	
20/40ER20	ISO 40	47	34	ER 20	1-13	
20/40ER25	ISO 40	60	42	ER 25	1-16	
20/404ER32	ISO 40	49	50	ER 32	2-20	
20/40ER32	ISO 40	70	50	ER 32	2-20	
20/401ER32	ISO 40	100	50	ER 32	2-20	
20/405ER32	ISO 40	120	50	ER 32	2-20	
20/402ER32	ISO 40	140	50	ER 32	2-20	
20/403ER32	ISO 40	200	50	ER 32	2-20	
20/40ER40	ISO 40	50	63	ER 40	3-30	
20/402ER40	ISO 40	100	63	ER 40	3-30	
20/403ER40	ISO 40	120	63	ER 40	3-30	
20/401ER40	ISO 40	140	63	ER 40	3-30	
20/50ER32	ISO 50	70	50	ER 32	2-20	
20/50ER40	ISO 50	70	63	ER 40	3-30	

DIN 2080

Mandrini per macchine transfer Chucks for transfer machine



Articolo article	Attacco adapter	H	C	Pinza collect	Capacità capacity	Note
20/T3032/L060	ISO 30	60	50	ER 32	2-20	
20/T3032/L080	ISO 30	80	50	ER 32	2-20	
20/T3032/L100	ISO 30	100	50	ER 32	2-20	
20/T3032/L120	ISO 30	120	50	ER 32	2-20	
20/T3040/L060	ISO 30	60	63	ER 40	3-30	
20/T3040/L080	ISO 30	80	63	ER 40	3-30	
20/T3040/L090	ISO 30	90	63	ER 40	3-30	
20/T3040/L100	ISO 30	100	63	ER 40	3-30	
20/T3040/L120	ISO 30	120	63	ER 40	3-30	
20/T4032/L060	ISO 40	60	50	ER 32	2-20	
20/T4032/L080	ISO 40	80	50	ER 32	2-20	
20/T4032/L100	ISO 40	100	50	ER 32	2-20	
20/T4032/L120	ISO 40	120	50	ER 32	2-20	
20/T4040/L060	ISO 40	60	63	ER 40	3-30	
20/T4040/L080	ISO 40	80	63	ER 40	3-30	
20/T4040/L100	ISO 40	100	63	ER 40	3-30	
20/T4040/L120	ISO 40	120	63	ER 40	3-30	



Su richiesta si costruiscono altre misure
On request we produce also other measures

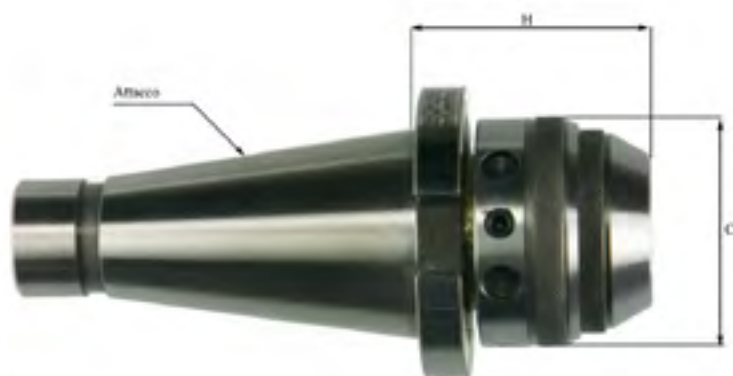

Mandrini portapinze grifo Grifo collet chucks

Articolo article	Attacco adapter	H	C	Pinza collect	Capacità capacity	Note
20/307GRIFO	ISO 30	63	62	ART.700	3-20	
20/407GRIFO	ISO 40	63	62	ART.700	3-20	
20/408GRIFO	ISO 40	79	82	ART.800	6-32	
20/457GRIFO	ISO 45	67	62	ART.700	3-20	
20/458GRIFO	ISO 45	69	82	ART.800	6-32	
20/507GRIFO	ISO 50	69	62	ART.700	3-20	
20/508GRIFO	ISO 50	69	82	ART.800	6-32	



Articoli disponibili solo fino ad esaurimento scorte
Available only until run out of stock

DIN 2080

Mandrini a forte serraggio Milling chuck



Articolo article	Attacco adapter	H	D	C	Pinza collect	Capacità capacity	Note
20/40/20FS	ISO 40	100	20	60	100/20	3-18	
20/40/32FS	ISO 40	105	32	73	100/32	4-28	
20/50/20FS	ISO 50	105	20	70	100/20	3-18	

Pinze cilindriche Cylindrical collets

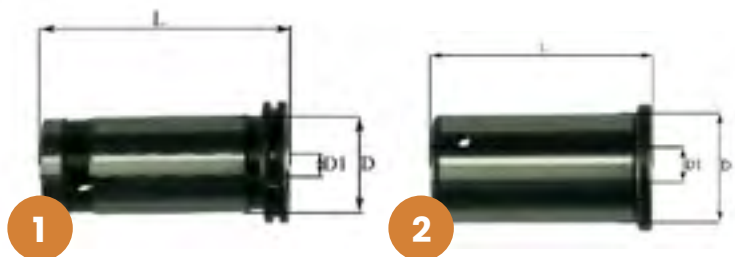

Articolo article	D	D1	L	Note
100/20	20	3-19	50	
100/25	25	3-22	58	
100/32	32	3-30	68	

A tenuta/Sealed:

100/20T	20	3-16	50	
100/25T	25	3-20	58	
100/32T	32	4-26	68	



Disponibili anche con misure decimali e in pollici
Available also with decimal and inch measurements



Mandrini attacco weldon Weldon milling holders

Articolo article	Attacco adapter	D	H	C	Note
20/40WE06	ISO 40	6	50	25	
20/40WE08	ISO 40	8	50	28	
20/40WE10	ISO 40	10	50	35	
20/40WE12	ISO 40	12	50	42	
20/40WE14	ISO 40	14	50	44	
20/40WE16	ISO 40	16	63	48	
20/40WE18	ISO 40	18	63	50	
20/40WE20	ISO 40	20	63	52	
20/40WE25	ISO 40	25	90	65	
20/40WE32	ISO 40	32	90	72	
20/40WE40	ISO 40	40	90	90	
20/50WE06	ISO 50	6	63	25	
20/50WE08	ISO 50	8	63	28	
20/50WE10	ISO 50	10	63	35	
20/50WE12	ISO 50	12	63	42	
20/50WE14	ISO 50	14	63	44	
20/50WE16	ISO 50	16	63	48	
20/50WE18	ISO 50	18	63	50	
20/50WE20	ISO 50	20	63	52	
20/50WE25	ISO 50	25	80	65	
20/50WE32	ISO 50	32	80	72	
20/50WE40	ISO 50	40	90	90	

Mandrini portafrese fissi

Shell milling holders



Articolo article	Attacco adapter	D	G	L	C	Note
20/40F16	ISO 40	16	45	17	38	
20/40F22	ISO 40	22	45	19	48	
20/40F27	ISO 40	27	45	21	58	
20/40F32	ISO 40	32	50	24	65	
20/50F16	ISO 50	16	45	17	38	
20/50F22	ISO 50	22	45	19	48	
20/50F27	ISO 50	27	45	21	58	
20/50F32	ISO 50	32	50	24	78	
20/50F40	ISO 50	40	50	27	88	



Prolunghe per P / Frese
Extentions for milling chucks

p.126
p.126

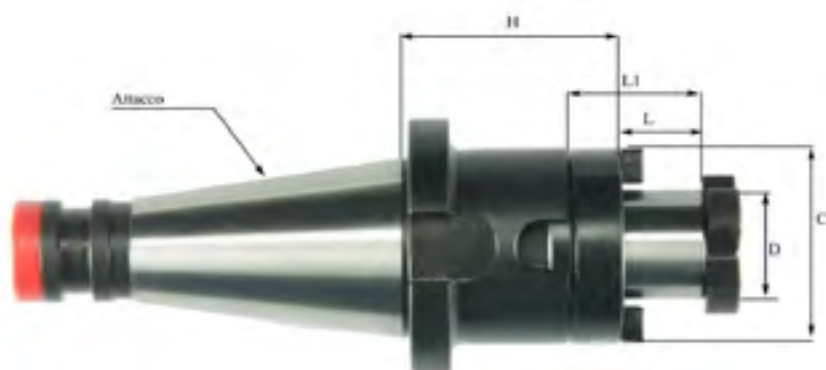

Mandrini portafrese combinati

Trascinamento frontale e chiavetta

Combined shell milling holders
Frontal dragging and key

Articolo article	Attacco adapter	D	C	H	L	L1	Note
20/40C16	ISO 40	16	32	52	17	27	
20/40C22	ISO 40	22	40	52	19	31	
20/40C27	ISO 40	27	48	52	21	33	
20/40C32	ISO 40	32	58	52	24	38	
20/50C16	ISO 50	16	32	55	17	27	
20/50C22	ISO 50	22	40	55	19	31	
20/50C27	ISO 50	27	48	55	21	33	
20/50C32	ISO 50	32	58	55	24	38	
20/50C40	ISO 50	40	70	55	27	41	

Riduzioni cono morse per frese

*Morse taper adaptor
for mills*

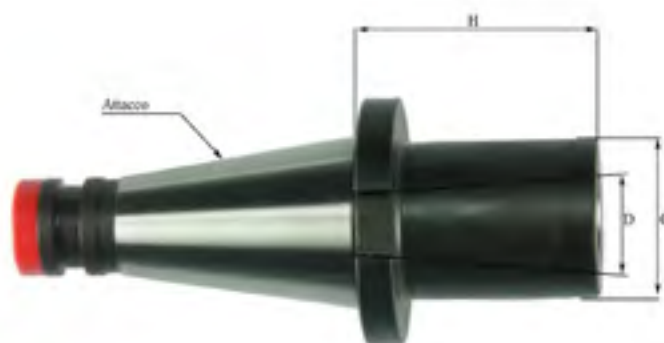

Articolo article	Attacco adapter	H	C	D	Note
20/40CM2F	ISO 40	50	32	CM 2	
20/40CM3F	ISO 40	65	40	CM 3	
20/40CM4F	ISO 40	95	48	CM 4	
20/50CM2F	ISO 50	60	32	CM 2	
20/50CM3F	ISO 50	65	40	CM 3	
20/50CM4F	ISO 50	65	48	CM 4	
20/50CM5F	ISO 50	120	63	CM 5	

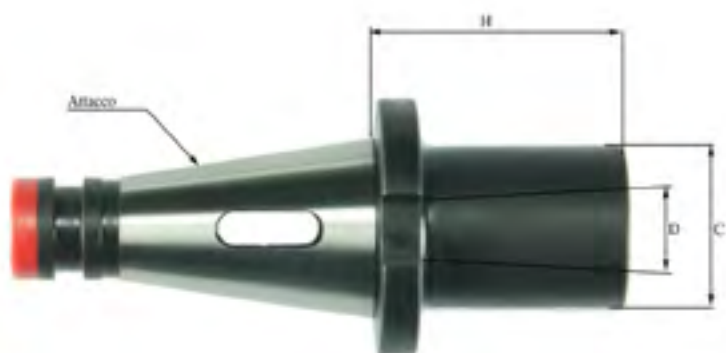

Riduzioni cono morse per punte

*Morse taper adaptor
for drills*

Articolo article	Attacco adapter	H	C	D	Note
20/40CM2P	ISO 40	50	32	CM 2	
20/40CM3P	ISO 40	65	40	CM 3	
20/40CM4P	ISO 40	95	48	CM 4	
20/50CM2P	ISO 50	60	32	CM 2	
20/50CM3P	ISO 50	65	40	CM 3	
20/50CM4P	ISO 50	70	48	CM 4	
20/50CM5P	ISO 50	100	63	CM 5	

DIN 2080

Attacchi per mandrini portapunte

Drill chucks arbors



Articolo article	Attacco adapter	H	B	Note
20/40B12	ISO 40	17	B 12	
20/40B16	ISO 40	17	B 16	
20/40B18	ISO 40	17	B 18	
20/50B16	ISO 50	20	B 16	
20/50B18	ISO 50	20	B 18	

Articolo article	Attacco adapter	Capacità capacity
35UP/08/B12	B 12	0-8
35UP/10/B12	B 12	0-10
35UP/10/B16	B 16	0-10
35UP/13/B16	B 16	1-13
35UP/16/B16	B 16	3-16
35UP/16/B18	B 18	3-16



Mandr. autoserranti serie ultra precisa *Ultra-precise keyless drill chucks*

Articolo article	Attacco adapter	Capacità capacity
35ST/08/B12	B 12	0-8
35ST/10/B12	B 12	0-10
35ST/13/B16	B 16	1-13
35ST/16/B16	B 16	3-16
35ST/16/B18	B 18	3-16



Mandr. autoserranti serie standard *Standard keyless drill chucks*





Brusa & C.
Tooling s.r.l

MAS - BT

Brusa & C. S.r.l.

03

p. 37

MAS - BT

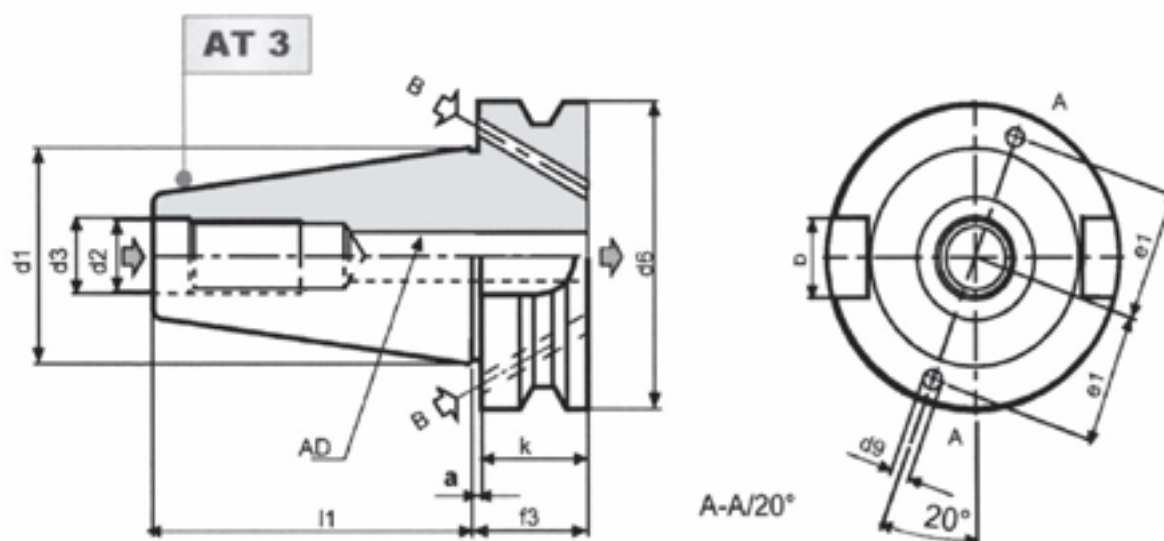

Cono Taper	d1	d2	d3	d6	e1	l1	a	k	f3	b
ISO 30	31,75	M12	12,5	46	21	48,4	2	20	22	16,1
ISO 40	44,45	M16	17	63	27	65,4	2	25	27	16,1
ISO 50	69,85	M24	25	100	42	101,8	3	35	38	25,7

Forma AD

Il lubrificante passa dal centro del mandrino.
The coolant through the center of the toolholders.

Forma AD + B

Il lubrificante passa dai fori sulla flangia.
 Tutti i mandrini vengono forniti con grani di chiusura.
The coolant through V-flange bores. All chucks are supplied with closure screws.

Bilanciatura *Balancing*

Mandrini prebilanciati in fase di costruzione.
Chucks pre-balanced under construction

ISO30 Rpm 20000

ISO40 Rpm 20000

ISO50 Rpm 10000



MAS - BT

Mandrini portapinze ER ER collet chucks

Articolo article	Attacco adapter	H	C	Pinza collect	Capacità capacity	Note
30/30ER25	BT 30 (A)	60	42	ER 25	1-16	
30/30ER32	BT 30 (A)	65	50	ER 32	2-20	
30/302ER32	BT 30 (A)	100	50	ER 32	2-20	
30/40BER16	BT 40 (AD+B)	70	32	ER 16	1-10	
30/402BER16	BT 40 (AD+B)	90	32	ER 16	1-10	
30/401BER16	BT 40 (AD+B)	120	32	ER 16	1-10	
30/40BER20	BT 40 (AD+B)	70	35	ER 20	1-13	
30/40ER25	BT 40 (A)	70	42	ER 25	1-16	
30/40BER25	BT 40 (AD+B)	70	42	ER 25	1-16	
30/401BER25	BT 40 (AD+B)	100	42	ER 25	1-16	
30/40ER32	BT 40 Standard (A)	70	50	ER 32	2-20	
30/40BER32	BT 40 Standard (AD+B)	70	50	ER 32	2-20	
30/401ER32	BT 40 (A)	100	50	ER 32	2-20	
30/402ER32	BT 40 (A)	140	50	ER 32	2-20	
30/403ER32	BT 40 (A)	200	50	ER 32	2-20	
30/40BER40	BT 40 (AD+B)	80	63	ER 40	3-30	
30/401BER40	BT 40 (AD+B)	100	63	ER 40	3-30	
30/402BER40	BT 40 (AD+B)	120	63	ER 40	3-30	
30/50BER32	BT 50 (AD+B)	80	50	ER 32	2-20	
30/50BER40	BT 50 (AD+B)	100	63	ER 40	3-30	

Su richiesta ghiera bilanciata per alta velocità per ER25 e ER32
on request balanced er nut ER32 for high speed

Su richiesta si costruiscono altre misure
On request we produce also other measures



MAS - BT

Mandrini a forte serraggio Milling chuck

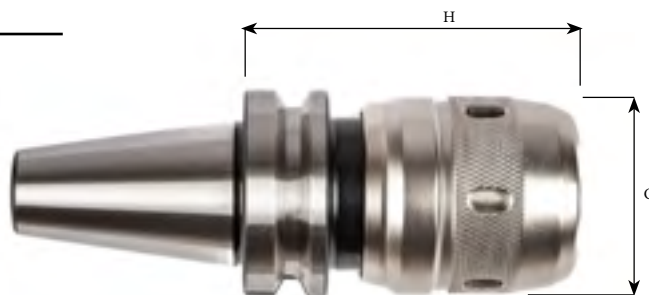

Articolo article	Attacco adapter	H	D	C	Art. pinza collect art.	Capacità capacity	Note
30/40/20FS	BT 40	100	20	60	100/20	3-18	
30/40/25FS	BT 40	105	25	60	100/25	3-22	
30/40/32FS	BT 40	115	32	73	100/32	3-26	
30/50/20FS	BT 50	110	20	70	100/20	3-18	
30/50/32FS	BT 50	120	32	73	100/32	3-26	

Pinze cilindriche Cylindrical collets

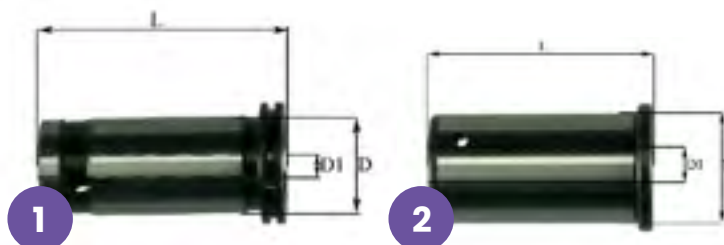

Articolo article	D	D1	L	Note
100/20	20	3-19	50	
100/25	25	3-22	58	
100/32	32	3-30	68	

A tenuta/Sealed:

100/20T	20	3-16	50	
100/25T	25	3-20	58	
100/32T	32	4-26	68	



Disponibili anche con misure decimali e in pollici
Available also with decimal and inch measurements



MAS - BT

Kit mandrini forte serraggio compl. di chiave *Kit milling chuck with key*

Articolo <i>article</i>	Attacco <i>adapter</i>	Pinza <i>collect</i>	Pinze nel kit <i>collet size on the kit</i>	Note
30/KIT40/20FS	ISO 40 DIAM. 20	100/20 Nr. 10 pz.	3-4-5-6-8-10-12-14-16-18	
30/KIT40/32FS	ISO 40 DIAM. 32	100/32 Nr. 12 pz.	4-5-6-8-10-12-14-16-18-20-25-28	

Mandrini a doppio contatto double contact chucks



Articolo <i>article</i>	Attacco <i>adapter</i>	H	C	Pinza <i>collet</i>	Note
30/40/DER32	BT40 FORMA AD+B	70	50	ER32	

Su richiesta si costruiscono in tutte le misure e in tutta la gamma
*On request we produce them also in others measures and
in a complete range of toolholders*



MAS - BT

Mandrini portafrese attacco weldon

Weldon milling holders



Articolo article	Attacco adapter	D	H	C	Note
30/40WE06	BT 40	6	50	25	
30/40WE08	BT 40	8	50	28	
30/40WE10	BT 40	10	63	35	
30/40WE12	BT 40	12	63	42	
30/40WE14	BT 40	14	63	44	
30/40WE16	BT 40	16	70	48	
30/40WE18	BT 40	18	70	50	
30/40WE20	BT 40	20	70	52	
30/40WE25	BT 40	25	100	65	
30/40WE32	BT 40	32	100	72	
30/40WE40	BT 40	40	120	90	
30/50WE06	BT 50	6	63	25	
30/50WE08	BT 50	8	63	28	
30/50WE10	BT 50	10	63	35	
30/50WE12	BT 50	12	80	42	
30/50WE14	BT 50	14	80	44	
30/50WE16	BT 50	16	80	48	
30/50WE20	BT 50	20	80	52	
30/50WE25	BT 50	25	100	65	
30/50WE32	BT 50	32	105	72	
30/50WE40	BT 50	40	120	80	
30/50WE50	BT 50	50	125	100	

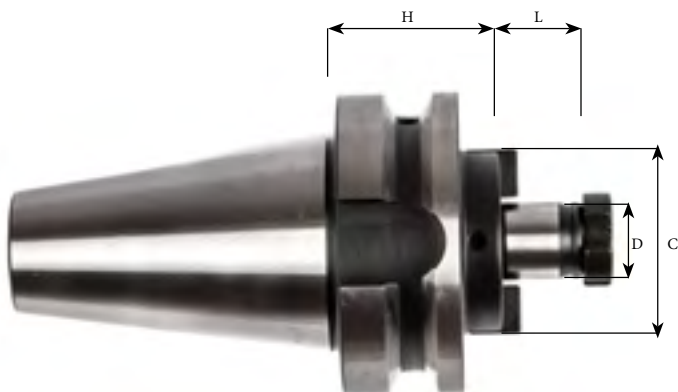

Mandrini portafrese fissi Shell milling holders

Articolo article	Attacco adapter	D	H	L	C	Note
30/40F16	BT 40	16	35	17	38	
30/40F22	BT 40	22	35	19	48	
30/40F27	BT 40	27	35	21	58	
30/40F32	BT 40	32	50	24	78	
30/40F40	BT 40	40	55	27	88	
30/50F16	BT 50	16	75	17	38	
30/50F22	BT 50	22	75	19	48	
30/50F27	BT 50	27	75	21	58	
30/50F32	BT 50	32	75	24	66	
30/50F40	BT 50	40	75	27	89	



Prolunghe per P / Frese
Extentions for milling chucks

p.126
p.126

MAS - BT



Mandrini portafrese combinati Trascinamento frontale e chiavetta

*Combined shell milling holders
Frontal dragging and key*

Articolo article	Attacco adapter	D1	D2	H	L	L1	Note
30/40C16	BT 40	16	32	55	17	27	
30/40C22	BT 40	22	40	55	19	31	
30/40C27	BT 40	27	48	55	21	33	
30/40C32	BT 40	32	58	60	24	38	
30/40C40	BT 40	40	70	60	27	41	
30/50C16	BT 50	16	32	70	17	27	
30/50C22	BT 50	22	40	70	19	31	
30/50C27	BT 50	27	48	70	21	33	
30/50C32	BT 50	32	58	70	24	38	
30/50C40	BT 50	40	70	70	27	41	



Riduzioni cono morse per frese

*Morse taper adaptor
for mills*

Articolo article	Attacco adapter	H	C	D	Note
30/40CM2F	BT 40	50	32	CM 2	
30/40CM3F	BT 40	70	40	CM 3	
30/40CM4F	BT 40	95	48	CM 4	
30/50CM2F	BT 50	60	32	CM 2	
30/50CM3F	BT 50	65	40	CM 3	
30/50CM4F	BT 50	85	48	CM 4	
30/50CM5F	BT 50	100	63	CM 5	

MAS - BT

Riduzioni cono morse per punte *Morse taper adaptor for drills*



Articolo article	Attacco adapter	H	C	D	Note
30/40CM1P	BT 40	50	25	CM 1	
30/40CM2P	BT 40	50	32	CM 2	
30/40CM3P	BT 40	70	40	CM 3	
30/40CM4P	BT 40	95	48	CM 4	
30/50CM2P	BT 50	60	32	CM 2	
30/50CM3P	BT 50	65	40	CM 3	
30/50CM4P	BT 50	95	48	CM 4	
30/50CM5P	BT 50	105	63	CM 5	



Attacchi per mandrini portapunte Drill chucks arbors

Articolo article	Attacco adapter	H	B	Note
30/40B12	BT 40	40	B 12	
30/40B16	BT 40	42	B 16	
30/40B18	BT 40	42	B 18	
30/50B16	BT 50	45	B 16	
30/50B18	BT 50	45	B 18	



Mandr. autoserranti serie ultra precisa *Ultra-precise keyless drill chucks*

Articolo article	Attacco adapter	Capacità capacity
35UP/08/B12	B 12	0-8
35UP/10/B12	B 12	0-10
35UP/10/B16	B 16	0-10
35UP/13/B16	B 16	1-13
35UP/16/B16	B 16	3-16
35UP/16/B18	B 18	3-16



Mandr. autoserranti serie standard *Standard keyless drill chucks*

Articolo article	Attacco adapter	Capacità capacity
35ST/08/B12	B 12	0-8
35ST/10/B12	B 12	0-10
35ST/13/B16	B 16	1-13
35ST/16/B16	B 16	3-16
35ST/16/B18	B 18	3-16



Brusa & C.
Tooling s.r.l

HSK

DIN 69893

forma A / form A

Brusa & C. S.r.l.

04

p. 49

HSK DIN 69893

Forma A / Form A

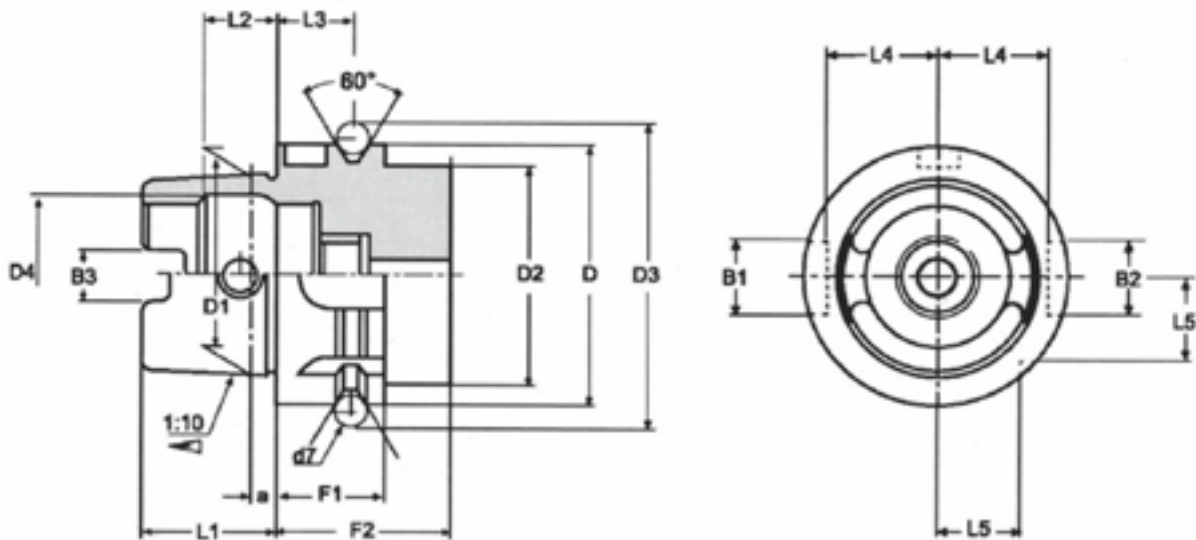

HSK	D	D1	D2	D3	B1	B2	B3	d7	L1	L2	L3	L4	L5	F1	F2
50	50	38	42	59,3	14	12	10,54	7	25	14,13	18	21	15,5	26	42
63	63	48	53	72,3	18	16	12,54	7	32	18,13	18	26,5	20	26	42
80	80	60	67	88,8	20	18	16,04	7	40	22,85	18	34	25	26	42
100	100	75	85	109,75	22	20	20,02	7	50	28,56	20	44	31,5	29	45

Bilanciatura *Balancing*

Mandrini prebilanciati in fase di costruzione.
Chucks pre-balanced under construction

HSK50 RpM 25000

HSK63 RpM 25000

HSK80 RpM 15000

HSK100 RpM 15000

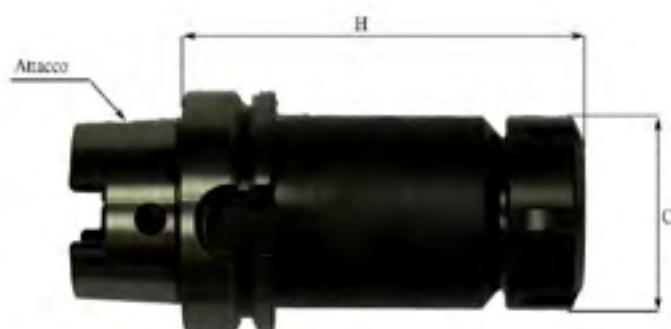

Mandrini portapinze HSK63A HSK63A collet chucks

Articolo article	Attacco adapter	D	H	C	Pinza collect	Capacità capacity	Note
40/63A/ER16	HSK 63 A	63	100	32	ER 16	1-10	
40/63A/ER16/160	HSK 63 A	63	160	32	ER 16	1-10	
40/63A/ER25	HSK 63 A	63	100	42	ER 25	1-16	
40/63A/ER25/120	HSK 63 A	63	120	42	ER 25	1-16	
40/63A/ER32	HSK 63 A	63	100	50	ER 32	2-20	
40/63A/ER32/1	HSK 63 A	63	120	50	ER 32	2-20	
40/63A/ER32/2	HSK 63 A	63	160	50	ER 32	2-20	
40/63A/ER32/3	HSK 63 A	63	200	50	ER 32	2-20	
40/63A/ER40	HSK 63 A	63	80	63	ER 40	3-30	
40/63A/ER40/2	HSK 63 A	63	90	63	ER 40	3-30	
40/63A/ER40/0	HSK 63 A	63	100	63	ER 40	3-30	
40/63A/ER40/1	HSK 63 A	63	120	63	ER 40	3-30	

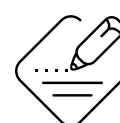

A richiesta HSK 40 / 50 / 80 / 100 Forme B / C / D / E / F
on request HSK 40 / 50 / 80 / 100 Forms B / C / D / E / F

DIN 69893

Mandrini portapinze HSK63F HSK63F collet chuck



Articolo article	Attacco adapter	D	H	C	Pinza collect	Capacità capacity	Note
40/63F/ER32	HSK 63 F	63	100	50	ER32	2-20	
40/63F/290	HSK 63 F	63	65	50	GRIFO290 pag. 106	3-25	



Su richiesta HSK 40 / 50 / 80 / 100
on request HSK 40 / 50 / 80 / 100

Adduttore refrigerante Collant tube



Articolo article	Attacco adapter	M	L	L1	D	Note
40/63A/M18	HSK 63/A	18 x 1	36	11,50	12	
40/63F/M16	HSK 63/F - 50/A - 50E	16 x 1	33	9,5	10	

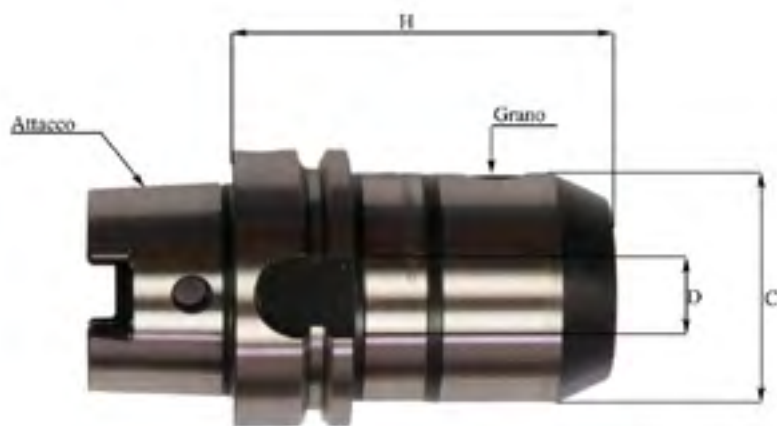

Mandrini portafrese weldon attacco HSK63A

*HSK63A weldon
milling holders*

Articolo article	Attacco adapter	D	H	C	Note
40/63A/WE06	HSK 63 A	6	65	25	
40/63A/WE08	HSK 63 A	8	65	28	
40/63A/WE10	HSK 63 A	10	65	35	
40/63A/WE12	HSK 63 A	12	80	42	
40/63A/WE16	HSK 63 A	16	80	48	
40/63A/WE20	HSK 63 A	20	80	52	
40/63A/WE25	HSK 63 A	25	110	65	
40/63A/WE32	HSK 63 A	32	110	72	

DIN 69893

Mandrini portafrese fisso Hsk63A shell milling holders

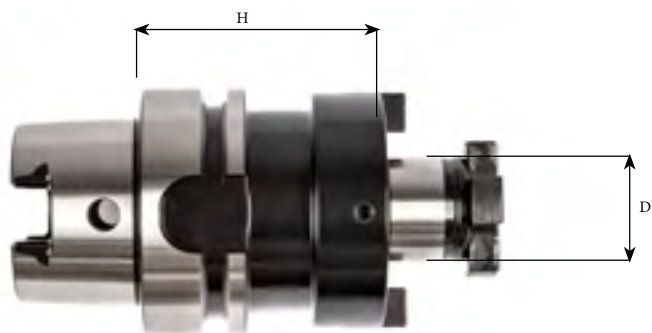

Articolo article	Attacco adapter	D	H	Note
40/63A/F16	HSK 63 A	16	45	
40/63A/F22	HSK 63 A	22	50	
40/63A/F27	HSK 63 A	27	50	
40/63A/F32	HSK 63 A	32	60	



Su richiesta si costruiscono altre misure
On request we produce also other measures

Mandrini portafrese combinato HSK63A combined shell milling holders

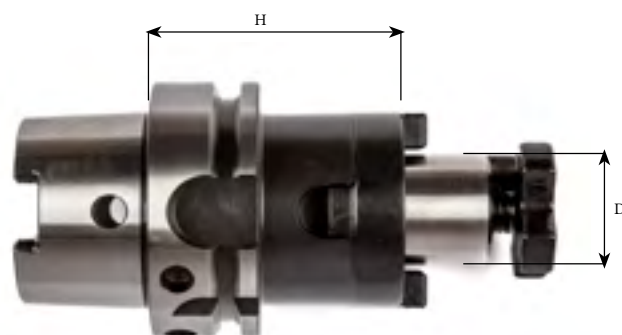

Articolo article	Attacco adapter	D	H	Note
40/63A/C16	HSK 63 A	16	60	
40/63A/C22	HSK 63 A	22	60	
40/63A/C27	HSK 63 A	27	60	
40/63A/C32	HSK 63 A	32	60	



Su richiesta si costruiscono altre misure
On request we produce also other measures

DIN 69893

Mandrini con stelo tenero lavorabile

HSK chucks with machinable blank arbors

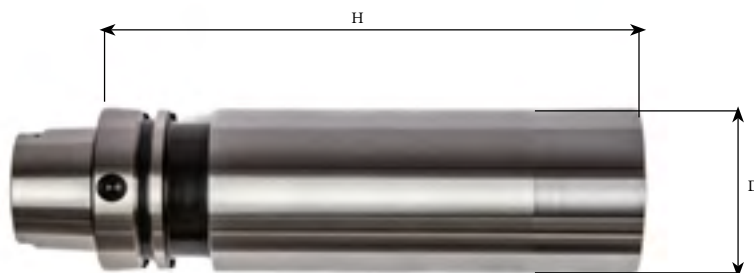

Articolo article	Attacco adapter	H	D	Note
40/63A/ST63	HSK 63 A	250	63	
40/63A/ST63.2	HSK 63 A	200	63	
40/63A/ST80	HSK 63 A	250	80	
40/100A/ST63	HSK 100 A	200	63	
40/100A/ST90	HSK 100 A	250	95	



Su richiesta si costruiscono altre misure
On request we produce also other measures





Brusa & C.
Tooling s.r.l

Mandrini a calettamento termico

Shrink fit toolholders

Brusa & C. S.r.l.

05

p. 59

DIN 69871

Mandrini a calettamento termico Shrink fit toolholders

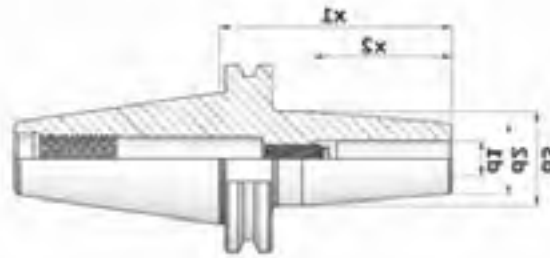

G 2,5 RpM 25.000

Articolo article	Attacco adapter	d1	d2	d3	x1	x2	Note
10/40SF/03-080	ISO 40	3	15	20	80	-	
10/40SF/03-120	ISO 40	3	15	20	120	-	
10/40SF/04-080	ISO 40	4	15	20	80	-	
10/40SF/04-120	ISO 40	4	15	20	120	-	
10/40SF/05-080	ISO 40	5	15	20	80	-	
10/40SF/05-120	ISO 40	5	15	20	120	-	
10/40SF/06-080	ISO 40	6	20	27	80	36	
10/40SF/06-120	ISO 40	6	20	27	120	36	
10/40SF/06-160	ISO 40	6	20	27	160	36	
10/40SF/08-080	ISO 40	8	20	27	80	36	
10/40SF/08-120	ISO 40	8	20	27	120	36	
10/40SF/08-160	ISO 40	8	20	27	160	36	
10/40SF/10-080	ISO 40	10	24	32	80	42	
10/40SF/10-120	ISO 40	10	24	32	120	42	
10/40SF/10-160	ISO 40	10	24	32	160	42	
10/40SF/12-080	ISO 40	12	24	32	80	47	
10/40SF/12-120	ISO 40	12	24	32	120	47	
10/40SF/12-160	ISO 40	12	24	32	160	47	
10/40SF/14-080	ISO 40	14	27	34	80	47	
10/40SF/14-120	ISO 40	14	27	34	120	47	
10/40SF/14-160	ISO 40	14	27	34	160	47	
10/40SF/16-080	ISO 40	16	27	34	80	50	
10/40SF/16-120	ISO 40	16	27	34	120	50	
10/40SF/16-160	ISO 40	16	27	34	160	50	
10/40SF/18-080	ISO 40	18	33	42	80	50	
10/40SF/18-120	ISO 40	18	33	42	120	50	
10/40SF/18-160	ISO 40	18	33	42	160	50	
10/40SF/20-080	ISO 40	20	33	42	80	52	
10/40SF/20-120	ISO 40	20	33	42	120	52	
10/40SF/20-160	ISO 40	20	33	42	160	52	
10/40SF/25-100	ISO 40	25	44	53	100	58	
10/40SF/25-160	ISO 40	25	44	53	160	58	
10/40SF/25-200	ISO 40	25	44	53	200	58	
10/40SF/32-100	ISO 40	32	44	53	100	63	
10/40SF/32-160	ISO 40	32	44	53	160	63	
10/40SF/32-200	ISO 40	32	44	53	200	63	

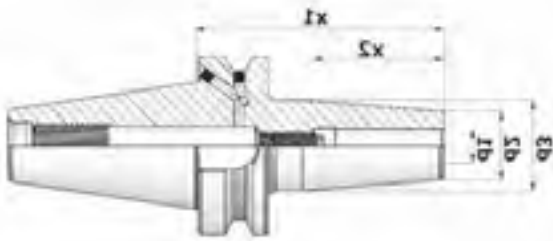

BT

Mandrini a calettamento termico
Shrink fit toolholders

G 2,5 RpM 25.000

Articolo article	Attacco adapter	d1	d2	d3	x1	x2	Note
30/40SF/03-090	BT 40	3	15	20	90	-	
30/40SF/03-120	BT 40	3	15	20	120	-	
30/40SF/04-090	BT 40	4	15	20	90	-	
30/40SF/04-120	BT 40	4	15	20	120	-	
30/40SF/05-090	BT 40	5	15	20	90	-	
30/40SF/05-120	BT 40	5	15	20	120	-	
30/40SF/06-090	BT 40	6	20	27	90	36	
30/40SF/06-120	BT 40	6	20	27	120	36	
30/40SF/06-160	BT 40	6	20	27	160	36	
30/40SF/08-090	BT 40	8	20	27	90	36	
30/40SF/08-120	BT 40	8	20	27	120	36	
30/40SF/08-160	BT 40	8	20	27	160	36	
30/40SF/10-090	BT 40	10	24	32	90	42	
30/40SF/10-120	BT 40	10	24	32	120	42	
30/40SF/10-160	BT 40	10	24	32	160	42	
30/40SF/12-090	BT 40	12	24	32	90	47	
30/40SF/12-120	BT 40	12	24	32	120	47	
30/40SF/12-160	BT 40	12	24	32	160	47	
30/40SF/14-090	BT 40	14	27	34	90	47	
30/40SF/14-120	BT 40	14	27	34	120	47	
30/40SF/14-160	BT 40	14	27	34	160	47	
30/40SF/16-090	BT 40	16	27	34	90	50	
30/40SF/16-120	BT 40	16	27	34	120	50	
30/40SF/16-160	BT 40	16	27	34	160	50	
30/40SF/18-090	BT 40	18	33	42	90	50	
30/40SF/18-120	BT 40	18	33	42	120	50	
30/40SF/18-160	BT 40	18	33	42	160	50	
30/40SF/20-090	BT 40	20	33	42	90	52	
30/40SF/20-120	BT 40	20	33	42	120	52	
30/40SF/20-160	BT 40	20	33	42	160	52	
30/40SF/25-100	BT 40	25	44	53	100	58	
30/40SF/25-160	BT 40	25	44	53	160	58	
30/40SF/25-200	BT 40	25	44	53	200	58	
30/40SF/32-100	BT 40	32	44	53	100	63	
30/40SF/32-160	BT 40	32	44	53	160	63	
30/40SF/32-200	BT 40	32	44	53	200	63	

HSK63A

DIN 69893

**Mandrini a
calettamento termico**
Shrink fit toolholders

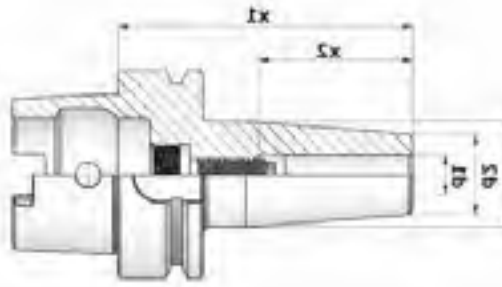

G 2,5 RpM 25.000

Articolo article	Attacco adapter	d1	d2	d3	x1	x2	Note
40/63ASF/03-080	HSK 63 A	3	15	20	80	-	
40/63ASF/03-120	HSK 63 A	3	15	20	120	-	
40/63ASF/04-080	HSK 63 A	4	15	20	80	-	
40/63ASF/04-120	HSK 63 A	4	15	20	120	-	
40/63ASF/05-080	HSK 63 A	5	15	20	80	-	
40/63ASF/05-120	HSK 63 A	5	15	20	120	-	
40/63ASF/06-080	HSK 63 A	6	20	27	80	36	
40/63ASF/06-120	HSK 63 A	6	20	27	120	36	
40/63ASF/06-160	HSK 63 A	6	20	27	160	36	
40/63ASF/08-080	HSK 63 A	8	20	27	80	36	
40/63ASF/08-120	HSK 63 A	8	20	27	120	36	
40/63ASF/08-160	HSK 63 A	8	20	27	160	36	
40/63ASF/10-085	HSK 63 A	10	24	32	85	42	
40/63ASF/10-120	HSK 63 A	10	24	32	120	42	
40/63ASF/10-160	HSK 63 A	10	24	32	160	42	
40/63ASF/12-090	HSK 63 A	12	24	32	90	47	
40/63ASF/12-120	HSK 63 A	12	24	32	120	47	
40/63ASF/12-160	HSK 63 A	12	24	32	160	47	
40/63ASF/14-090	HSK 63 A	14	27	34	90	47	
40/63ASF/14-120	HSK 63 A	14	27	34	120	47	
40/63ASF/14-160	HSK 63 A	14	27	34	160	47	
40/63ASF/16-095	HSK 63 A	16	27	34	95	50	
40/63ASF/16-120	HSK 63 A	16	27	34	120	50	
40/63ASF/16-160	HSK 63 A	16	27	34	160	50	
40/63ASF/18-095	HSK 63 A	18	33	42	95	50	
40/63ASF/18-120	HSK 63 A	18	33	42	120	50	
40/63ASF/18-160	HSK 63 A	18	33	42	160	50	
40/63ASF/20-100	HSK 63 A	20	33	42	100	52	
40/63ASF/20-120	HSK 63 A	20	33	42	120	52	
40/63ASF/20-160	HSK 63 A	20	33	42	160	52	
40/63ASF/25-115	HSK 63 A	25	44	53	115	58	
40/63ASF/25-160	HSK 63 A	25	44	53	160	58	
40/63ASF/25-200	HSK 63 A	25	44	53	200	58	
40/63ASF/32-120	HSK 63 A	32	44	53	120	63	
40/63ASF/32-160	HSK 63 A	32	44	53	160	63	
40/63ASF/32-200	HSK 63 A	32	44	53	200	63	





Brusa & C.
Tooling s.r.l

Mandrini poligonali capto ISO 26623-1

Polygonal taper toolholders ISO 26623-1

Brusa & C. S.r.l.

OG

p. 65

ISO 26623-1

Mandrini poligonali capto ISO 26623-1 *Polygonal taper toolholders ISO 26623-1*

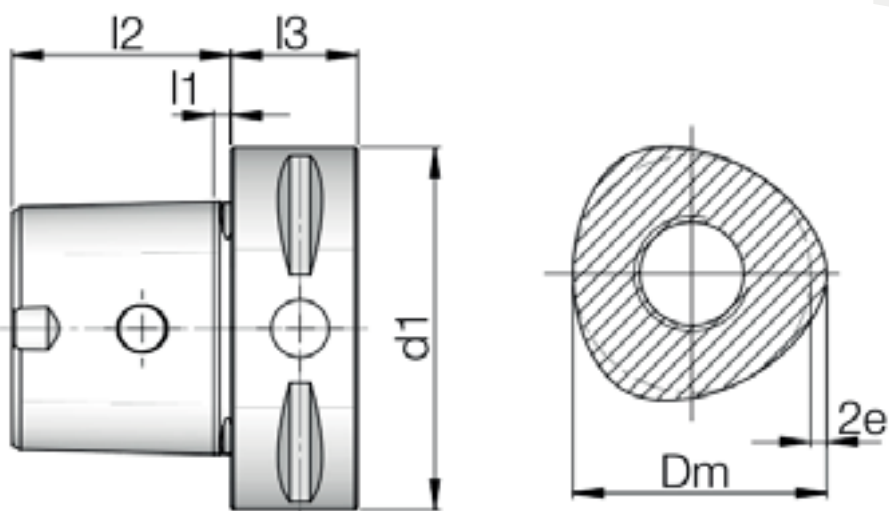

Tipo type	D_m	e	l_1	l_2	13 min.	Note
40-C4	28	0.90	2.50	24	20	
50-C5	35	1.12	3.00	30	20	
63-C6	44	1.40	3.00	38	38	
80-C8	55	2.00	3.00	48	40	

Bilanciatura *Balancing*

Bilanciati G2.5 RpM 2500
Balancing grade G2.5 RpM 25000

Portapinze ER bilanciati G2.5 RpM 25000

ER collet chuck

fine balanced G2.5 RpM 25000

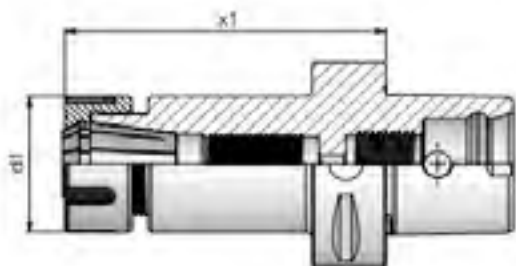

Articolo article	Tipo type	Pinza collet	x1	d1	Note
C4-40/ER16-70	40-C4	ER16	70	32	
C4-40/ER20-52	40-C4	ER20	52	35	
C4-40/ER25-52	40-C4	ER25	52	42	
C4-40/ER32-54	40-C4	ER32	54	50	
C5-50/ER16-55	50-C5	ER16	55	32	
C5-50/ER16-100	50-C5	ER16	100	32	
C5-50/ER20-55	50-C5	ER20	55	35	
C5-50/ER20-100	50-C5	ER20	100	35	
C5-50/ER25-55	50-C5	ER25	55	42	
C5-50/ER25-100	50-C5	ER25	100	42	
C5-50/ER32-57	50-C5	ER32	57	50	
C5-50/ER32-100	50-C5	ER32	100	50	
C5-50/ER40-60	50-C5	ER40	60	63	



ISO 26623-1

Portapinze ER bilanciati G2.5 RpM 25000 ER collet chuck fine balanced G2.5 RpM 25000



Articolo <i>article</i>	Tipo <i>type</i>	Pinza <i>collet</i>	x1	d1	Note
C6-63/ER16-60	63-C6	ER16	60	32	
C6-63/ER16-100	63-C6	ER16	100	32	
C6-63/ER20-60	63-C6	ER20	60	35	
C6-63/ER20-100	63-C6	ER20	100	35	
C6-63/ER25-60	63-C6	ER25	60	42	
C6-63/ER25-100	63-C6	ER25	100	42	
C6-63/ER32-60	63-C6	ER32	60	50	
C6-63/ER32-100	63-C6	ER32	100	50	
C6-63/ER32-130	63-C6	ER32	130	50	
C6-63/ER40-65	63-C6	ER40	65	63	
C6-63/ER40-120	63-C6	ER40	120	63	
C8-80/ER16-65	80-C8	ER16	65	32	
C8-80/ER16-100	80-C8	ER16	100	32	
C8-80/ER20-65	80-C8	ER20	65	35	
C8-80/ER20-100	80-C8	ER20	100	35	
C8-80/ER25-70	80-C8	ER25	70	42	
C8-80/ER25-100	80-C8	ER25	100	42	
C8-80/ER32-70	80-C8	ER32	70	50	
C8-80/ER32-100	80-C8	ER32	100	50	
C8-80/ER32-130	80-C8	ER32	130	50	
C8-80/ER32-160	80-C8	ER32	160	50	
C8-80/ER40-70	80-C8	ER40	70	63	

Portafrese fisso bilanciati G2.5 RpM 25000 *Shell mill holders fine balanced G2.5 RpM 25000*

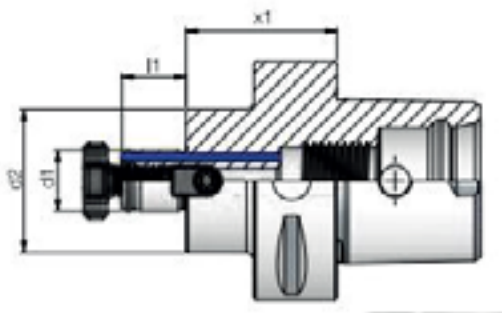

Articolo article	Tipo type	d1	d2	l1	x1	Note
C4-40/F16	40-C4	16	28	17	35	
C4-40/F22	40-C4	22	35	19	25	
C5-50/F16	50-C5	16	38	17	35	
C5-50/F22	50-C5	22	48	19	25	
C5-50/F27	50-C5	27	56	21	25	
C5-50/F32	50-C5	32	63	24	40	
C6-63/F16	63-C6	16	38	17	40	
C6-63/F22	63-C6	22	48	19	25	
C6-63/F27	63-C6	27	56	21	25	
C6-63/F32	63-C6	32	63	24	30	
C6-63/F40	63-C6	40	87	27	30	
C8-80/F16	C8-80	16	38	17	50	
C8-80/F22	C8-80	22	48	19	30	
C8-80/F27	C8-80	27	56	21	30	
C8-80/F32	C8-80	32	63	24	30	
C8-80/F40	C8-80	40	87	27	60	

ISO 26623-1

Portafrese weldon bilanciati
G2.5 RpM 25000
Weldon end mill holders
fine balanced
G2.5 RpM 25000

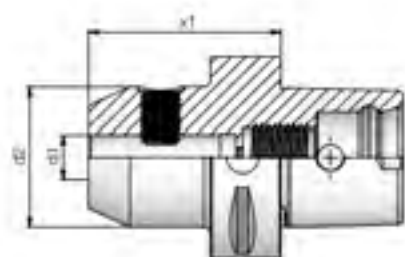

Su richiesta anche altre misure, attacchi e calettamento termico
On request also: other measures, other adapters and shrink fit toolholders

Articolo article	Tipo type	d1	d2	x1	Note
C4-40/WE06	40-C4	6	25	50	
C4-40/WE08	40-C4	8	28	50	
C4-40/WE10	40-C4	10	35	50	
C4-40/WE12	40-C4	12	42	55	
C4-40/WE14	40-C4	14	44	55	
C4-40/WE16	40-C4	16	48	55	
C5-50/WE06	50-C5	6	25	50	
C5-50/WE08	50-C5	8	28	50	
C5-50/WE10	50-C5	10	35	55	
C5-50/WE12	50-C5	12	42	60	
C5-50/WE14	50-C5	14	44	60	
C5-50/WE16	50-C5	16	48	60	
C5-50/WE18	50-C5	18	50	60	
C5-50/WE20	50-C5	20	52	60	
C5-50/WE25	50-C5	25	65	80	
C6-63/WE06	63-C6	6	25	55	
C6-63/WE08	63-C6	8	28	55	
C6-63/WE10	63-C6	10	35	60	
C6-63/WE12	63-C6	12	42	60	
C6-63/WE14	63-C6	14	44	60	
C6-63/WE16	63-C6	16	48	65	
C6-63/WE18	63-C6	18	50	65	
C6-63/WE20	63-C6	20	52	65	
C6-63/WE25	63-C6	25	65	80	
C6-63/WE32	63-C6	32	72	90	
C6-63/WE40	63-C6	40	90	100	
C8/80/WE06	80-C8	6	25	70	
C8/80/WE08	80-C8	8	28	70	
C8/80/WE10	80-C8	10	35	70	
C8/80/WE12	80-C8	12	42	70	
C8/80/WE14	80-C8	14	44	70	
C8/80/WE16	80-C8	16	48	70	
C8/80/WE18	80-C8	18	50	70	
C8/80/WE20	80-C8	20	52	70	
C8/80/WE25	80-C8	25	65	80	
C8/80/WE32	80-C8	32	72	80	
C8/80/WE40	80-C8	40	90	110	

Stelo tenero lavorabile prebilanciati *Blank bars prebalanced*



Articolo <i>article</i>	Tipo <i>type</i>	d1	x1	Note
C4-40/40ST100	40-C4	40	100	
C4-40/40ST200	40-C4	40	200	
C4-40/63ST200	40-C4	63	200	
C4-40/80ST100	40-C4	80	100	
C5-50/50ST100	50-C5	50	100	
C5-50/50ST200	50-C5	50	200	
C5-50/63ST200	50-C5	63	200	
C5-50/80ST100	50-C5	80	100	
C6-63/63ST160	63-C6	63	160	
C6-63/63ST250	63-C6	63	250	
C6-63/80ST200	63-C6	80	200	
C6-63/100ST160	63-C6	100	160	
C8-80/80ST160	80-C8	80	160	
C8-80/80ST250	80-C8	80	250	
C8-80/100ST160	80-C8	100	160	
C8-80/100ST250	80-C8	100	250	



Brusa & C.
Tooling s.r.l

Cono Morse

Morse taper

Brusa & C. S.r.l.

07

p. 73

Cono morse Morse taper

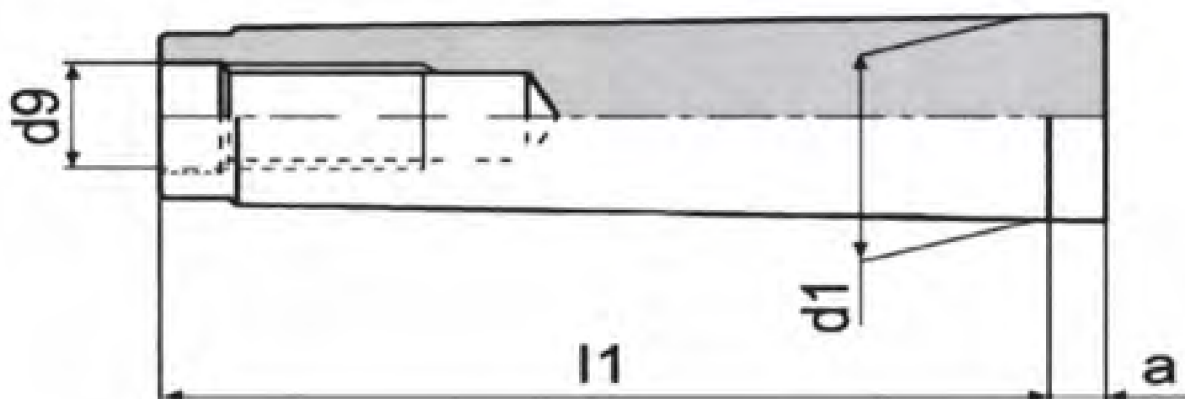

Morse	d_1	a	d_9	l_1
CM 2	17,78	5	M 10	64
CM 3	23,825	5	M 12	81
CM 4	31,267	6,5	M 16	102,5
CM 5	44,399	6,5	M 20	129,5

Precisione conicità AT 3 *Taper accuracy AT 3*

Cono morse Morse taper



Mandrini portapinze grifo cono morse 4 rag per famup

Grifo morse 4 rag collet chuck for famup

Articolo article	Attacco adapter	H	C	Ghiera nut	Pinza collet	Capacità capacity	Note
50/RAG/ER32	CM 4	44	50	RAG FIL.60x2,5	ER32	2-20	



ART.50/RAG/KIT32

Confezione mandrino portapinze GRIFO CM4 con ghiera RAG completa di Nr.7 pinze ER32 nei diam. 4-6-8-10-12-16-20 e chiave di servizio.

Kit GRIFO collet spindle with RAG nut completed by N°7 collets ER32 diam. 4-6-8-10-12-16-20 and service key.

DIN 228 / A

Mandrini ER attacco cono morse ER morse collet chuck



Articolo article	Attacco adapter	H	C	Pinza collect	Capacità capacity	Note
50/CM2ER16	CM 2	42	32	ER 16	1-10	
50/CM2ER20	CM 2	50	35	ER 20	1-13	
50/CM2ER25	CM 2	54	42	ER 25	1-16	
50/CM3ER25	CM 3	53	42	ER 25	1-16	
50/CM3ER32	CM 3	70	50	ER 32	2-20	
50/CM4ER32	CM 4	50	50	ER 32	2-20	
50/CM4ER40	CM 4	70	63	ER 40	3-30	
50/CM5ER32	CM 5	50	50	ER 32	2-20	
50/CM5ER40	CM 5	82	63	ER 40	3-30	

Mandrini grifo attacco como morse Grifo morse collet chuck



Articolo article	Attacco adapter	H	C	Pinza collect	Capacità capacity	Note
** 50/CM2G	CM 2	69	62	ART.700	3-20	
** 50/CM3G	CM 3	75	62	ART.700	3-20	
** 50/CM4G	CM 4	80	62	ART.700	3-20	
** 50/CM5G	CM 5	78	62	ART.700	3-20	



Articoli disponibili solo fino ad esaurimento scorte
Available only until run out of stock

Cono morse Morse taper

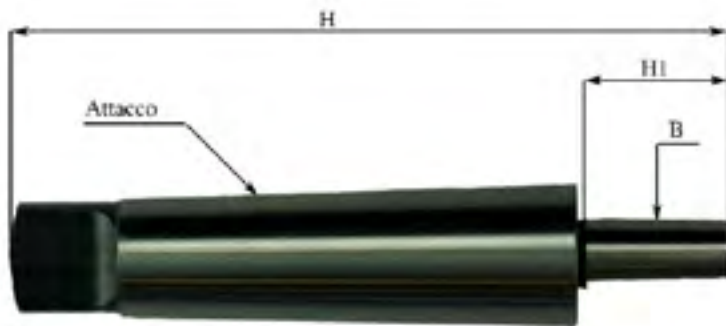

Attacco mandrino portapunte cono morse

Morse drill chucks arbors

Articolo article	Attacco adapter	B	H	HI	Note
50/CM2/16	CM 2	B 16	112	30	
50/CM3/16	CM 3	B 16	134	30	
50/CM3/18	CM 3	B 18	140	37	
50/CM4/16	CM 4	B 16	159	30	
50/CM4/18	CM 4	B 18	140	37	



Tenoni per attacchi cono morse

Removable tangs for morse taper shanks

Articolo article	Attacco adapter	M	Note
50/CM2	CONO MORSE 2	M 10	
50/CM3	CONO MORSE 3	M 12	
50/CM4	CONO MORSE 4	M 16	
50/CM5	CONO MORSE 5	M 20	



Brusa & C.
Tooling S.r.l

Portapinze cilindrici **straight shank tooling**

Brusa & C. S.r.l.

08

p. 79

Portapinze ER cilindrici standard e prolungati

Standard and
extension straight
shank collet chuck



Articolo article	Diam.	H	Ghiera nut	C-diam. Ghiera C-nut diam.	Pinza collect	Capacità capacity	Note
60/D8ER8	8	100	MINI	12	ER8	1-5	
60/D10ER8	10	100	MINI	12	ER8	1-5	
60/D12ER8	12	100	MINI	12	ER8	1-5	
60/D16ER11	16	100	MINI	16	ER11	1-7	
60/D16ER11P	16	150	MINI	16	ER11	1-7	
60/D16ER16	16	100	MINI	22	ER16	1-10	
60/D16ER16P	16	150	MINI	22	ER16	1-10	
60/D20ER16	20	100	MINI	22	ER16	1-10	
60/D20ER16P	20	150	MINI	22	ER16	1-10	
60/D20ER20	20	100	MINI	28	ER20	1-13	
60/D20ER20P	20	150	MINI	28	ER20	1-13	
60/D20ER25	20	100	MINI	35	ER25	1-16	
60/D25ER25	25	100	MINI	35	ER25	1-16	
60/D32ER25	32	60	STANDARD	42	ER25	1-16	
60/D25ER32	25	100	STANDARD	50	ER32	2-20	
60/D25ER32P	25	150	STANDARD	50	ER32	2-20	
60/D32ER32	32	70	STANDARD	50	ER32	2-20	
60/D40ER32	40	80	STANDARD	50	ER32	2-20	
60/D25ER40	25	150	STANDARD	63	ER40	3-30	
60/D32ER40	32	50	STANDARD	63	ER40	3-30	



Su richiesta si costruiscono altre misure
On request we produce also other measures



**Kit portapinze ER cilindrici
standard compl. di chiave**
*Kit standard straight shank
collet chucks with wrench*

Articolo article	Diam.	L	Ghiera nut	Pinza collet	Pinze nel kit collets on kit	Note
60/16ER11	16	100	MINI	Nr. 7 pz. ER11	1-2-3-4-5-6-7	
60/16ER16	16	100	MINI	Nr. 10 pz. ER16	1-2-3-4-5-6-7-8-9-10	
60/20ER16	20	100	MINI	Nr. 10 pz. ER16	1-2-3-4-5-6-7-8-9-10	
60/20ER20	20	100	MINI	Nr. 13 pz. ER20	1-2-3-4-5-6-7-8-9-10-11-12-13	
60/20ER25	20	100	MINI	Nr. 15 pz. ER25	1-2-3-4-5-6-7-8-9-10-11 12-13-14-15	
60/25ER25	25	150	MINI	Nr. 15 pz. ER25	1-2-3-4-5-6-7-8-9-10-11 12-13-14-15	
60/32ER25	32	60	STANDARD	Nr. 15 pz. ER25	1-2-3-4-5-6-7-8-9-10-11 12-13-14-15	



**Su richiesta serie in valigetta con stesso numero
di pinze ma con diametri a scelta**
*On request is possible to make customized set with different diameters but
with the same number of collets*



Brusa & C.
Tooling s.r.l

Accessori / Ricambi

Spare parts

Brusa & C. S.r.l.

09

p. 83

DIN 6499 / B

Pinze ER standard Standard ER collets

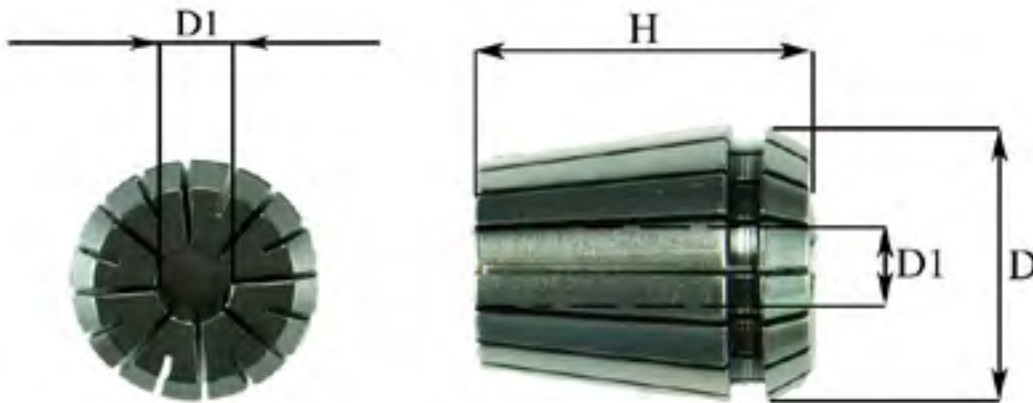

Conicità / taper 8° - Raggio / radius 30°

Concentricità / concentricity:

Pinza standard / standard collet mm. 0,008 - 0,012

Valori riferiti al diametro nominale delle pinze.

L'utensile deve essere bloccato per tutta la lunghezza utile di presa della pinza.

The tolerances are valid only for nominal diameter of the collet.

The chucking length of cutting tool shank is longer than the collet's bore length.

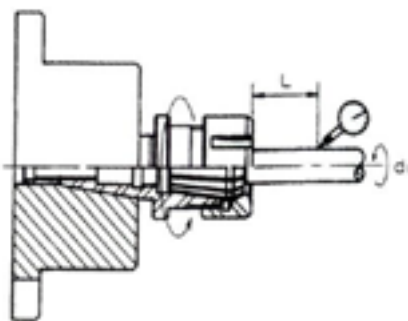

L (mm)	D1 (mm)	Concentricità standard standard concentricity
6	1,0 - 1,4	0,008
10	1,5 - 2,9	0,008
16	3,0 - 5,9	0,008
25	6,0 - 9,9	0,008
40	10,0 - 17,9	0,012
50	18,0 - 26,9	0,012
60	27,0 - 34,0	0,012

DIN 6499 / B

Pinze ER standard Standard ER collets

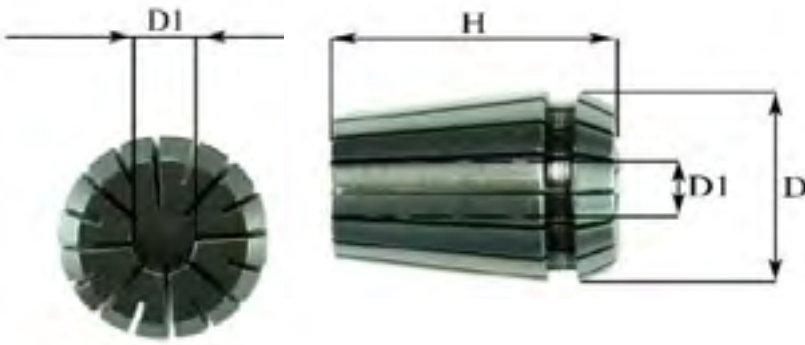

	D	H	Articolo article	D1 - capacità D1 - clamping range	Note
ER 8 STANDARD	8	13,5	ER8/D01	1-0,5	
			ER8/D01,5	1,5-1	
			ER8/D02	2-1,5	
			ER8/D02,5	2,5-2	
			ER8/D03	3-2,5	
			ER8/D03,5	3,5-3	
			ER8/D04	4-3,5	
			ER8/D04,5	4,5-4	
			ER8/D05	5-4,5	
ER 11 STANDARD	11	18	ER11/D01	1-0,5	
			ER11/D01,5	1,5-1	
			ER11/D02	2-1,5	
			ER11/D02,5	2,5-2	
			ER11/D03	3-2,5	
			ER11/D03,5	3,5-3	
			ER11/D04	4-3,5	
			ER11/D04,5	4,5-4	
			ER11/D05	5-4,5	
			ER11/D05,5	5,5-5	
			ER11/D06	6-5,5	
Over size		15	ER11/D06,5	6,5-6	
			ER11/D07	7-6,5	
			ER11/D08	8-7,5	
ER 16 STANDARD	16	27,5	ER16/D01	1-0,5	
			ER16/D01,5	1,5-1	
			ER16/D02	2-1,5	
			ER16/D02,5	2,5-2	
			ER16/D03	3-2	
			ER16/D03,5	3,5-2,5	
			ER16/D04	4-3	
			ER16/D04,5	4,5-3,5	
			ER16/D05	5-4	
			ER16/D05,5	5,5-4,5	
			ER16/D06	6-5	
			ER16/D06,5	6,5-5,5	
			ER16/D07	7-6	
			ER16/D07,5	7,5-6,5	
			ER16/D08	8-7	
			ER16/D08,5	8,5-7,5	
ER16/D09	9-8				
ER16/D09,5	9,5-8,5				
ER16/D10	10-9				
Over size		23,5	ER16/D11	11-10	
Over size		23,5	ER16/D12	12-11	



DIN 6499 / B

Pinze ER standard Standard ER collets

	D	H	Articolo article	D1 - capacità D1 - clamping range	Note
ER 20 STANDARD	20	31,5	ER20/D01	1-0,5	
			ER20/D01,5	1,5-1	
			ER20/D02	2-1,5	
			ER20/D02,5	2,5-2	
			ER20/D03	3-2	
			ER20/D04	4-3	
			ER20/D05	5-4	
			ER20/D06	6-5	
			ER20/D07	7-6	
			ER20/D08	8-7	
			ER20/D09	9-8	
			ER20/D10	10-9	
			ER20/D11	11-10	
			ER20/D12	12-11	
			ER20/D13	13-12	
Over size	26	ER20/D14	14-13		
Over size	26	ER20/D15	15-14		
ER 25 STANDARD	25	34	ER25/D01	1-0,5	
			ER25/D01,5	1,5-1	
			ER25/D02	2-1,5	
			ER25/D02,5	2,5-2	
			ER25/D03	3-2	
			ER25/D04	4-3	
			ER25/D05	5-4	
			ER25/D06	6-5	
			ER25/D07	7-6	
			ER25/D08	8-7	
			ER25/D09	9-8	
			ER25/D10	10-9	
			ER25/D11	11-10	
			ER25/D12	12-11	
			ER25/D13	13-12	
			ER25/D14	14-13	
			ER25/D15	15-14	
ER25/D16	16-15				
Over size	27	ER25/D17	17-16		
Over size	27	ER25/D18	18-17		
Over size	27	ER25/D19	19-18		
Over size	27	ER25/D20	20-19	>>	

	D	H	Articolo article	D1 - capacità D1 - clamping range	Note
			ER32/D02	2-1,5	
			ER32/D02,5	2,5-2	
			ER32/D03	3-2	
			ER32/D03,5	3,5-3	
			ER32/D04	4-3	
			ER32/D04,5	4,5-3,5	
			ER32/D05	5-4	
			ER32/D05,5	5,5-4,5	
			ER32/D06	6-5	
			ER32/D06,5	6,5-5,5	
			ER32/D07	7-6	
			ER32/D07,5	7,5-6,5	
			ER32/D08	8-7	
			ER32/D08,5	8,5-7,5	
			ER32/D09	9-8	
			ER32/D09,5	9,5-8,5	
			ER32/D10	10-9	
			ER32/D10,5	10,5-9,5	
			ER32/D11	11-10	
			ER32/D11,5	11,5-10,5	
ER 32 STANDARD	32	40	ER32/D12	12-11	
			ER32/D12,5	12,5-11,5	
			ER32/D13	13-12	
			ER32/D13,5	13,5-12,5	
			ER32/D14	14-13	
			ER32/D14,5	14,5-13,5	
			ER32/D15	15-14	
			ER32/D15,5	15,5-14,5	
			ER32/D16	16-15	
			ER32/D16,5	16,5-15,5	
			ER32/D17	17-16	
			ER32/D17,5	17,5-16,5	
			ER32/D18	18-17	
			ER32/D18,5	18,5-17,5	
			ER32/D19	19-18	
			ER32/D19,5	19,5-18,5	
			ER32/D20	20-19	
Over size			ER32/D21	21-20	
Over size			ER32/D22	22-21	
Over size			ER32/D23	23-22	
Over size		37	ER32D/24	24-23	
Over size		35	ER32/D25	25-24	>>

DIN 6499 / B

Pinze ER standard Standard ER collets

	D	H	Articolo article	D1 - capacità D1 - clamping range	Note			
ER 40 STANDARD	40	46	ER40/D03	3-2				
			ER40/D04	4-3				
			ER40/D05	5-4				
			ER40/D06	6-5				
			ER40/D07	7-6				
			ER40/D08	8-7				
			ER40/D09	9-8				
			ER40/D10	10-9				
			ER40/D11	11-10				
			ER40/D12	12-11				
			ER40/D13	13-12				
			ER40/D14	14-13				
			ER40/D15	15-14				
			ER40/D16	16-15				
			ER40/D17	17-16				
			ER40/D18	18-17				
			ER40/D19	19-18				
			ER40/D20	20-19				
			ER40/D21	21-20				
			ER40/D22	22-21				
			ER40/D23	23-22				
			ER40/D24	24-23				
			ER40/D25	25-24				
			ER40/D26	26-25				
			ER40/D27	27-26				
			ER40/D28	28-27				
			ER40/D29	29-28				
			ER40/D30	30-29				
			Over size		37,7	ER40/D31	31-30	
			Over size		37,7	ER40/D32	32-31	
			ER 50 STANDARD	50	60	Dal 6 al 34		
			Over size	50	60	Dal 35 al 40		

Inch sizes

	D	H	Articolo article	D1 - Capacità D1 - Capacity	Note
ER 25 STANDARD	25	34	ER25/D1/2	1/2"	
			ER25/D1/4	1/4"	
			ER25/D1/8	1/8"	
ER 32 STANDARD	32	40	ER32/D1/2	1/2"	
			ER32/D1/4	1/4"	
			ER32/D1/8	1/8"	
			ER32/D3/4	3/4"	
			ER32/D3/8	3/8"	



Serie pinze ER standard in valigetta

*Standard ER collet set
on plastic box*

Articolo <i>article</i>	Diametri <i>diameters</i>	Nr. Pz. Tot.	Note
ER11/1-7	1-2-3-4-5-6-7	7	
ER16/1-10	1-2-3-4-5-6-7-8-9-10	10	
ER20/1-13	1-2-3-4-5-6-7-8-9-10-11-12-13	13	
ER25/2-16	2-3-4-5-6-7-8-9-10-11-12-13-14-15-16	15	
ER32/3-20	3-4-5-6-7-8-9-10-11-12	18	
ER32/2-22	2-3-4-5-6-7-8-9-10-11-12-13-14-15-16 17-18-19-20-22	20	
ER40/3-30	3-4-5-6-7-8-9-10-11-12-13-14-15-16-17-18-19-20-21 22-23-24-25-26-27-28-29-30	28	



**Su richiesta serie in valigetta con stesso numero
di pinze ma con diametri a scelta**
*On request is possible to make customized set with different diameters but
with the same number of collets*

DIN 6499 / B

Pinze ER ultra precise High precision ER collet

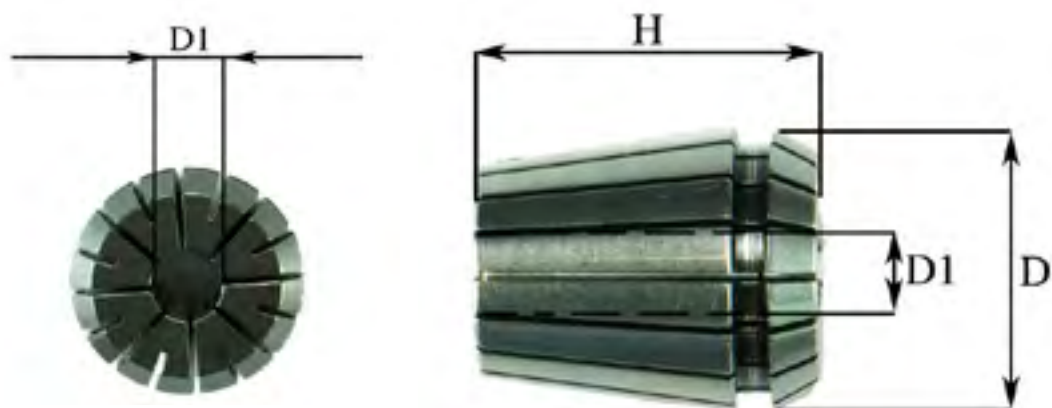

Conicità / taper 8° - Raggio / radius 30°

Concentricità / Concentricity: Pinza ultra precisa / mm. 0,005 - 0,008

Valori riferiti al diametro nominale delle pinze.

L'utensile deve essere bloccato per tutta la lunghezza utile di presa della pinza.

The tolerances are valid only for nominal diameter of the collet.

The chucking length of cutting tool shank is longer than the collet's bore length.

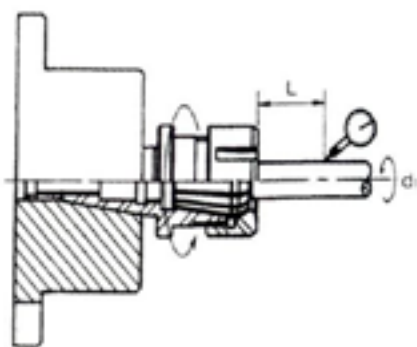

L (mm)	D1 (mm)	Concentricità standard standard concentricity
6	1,0 - 1,4	0,005
10	1,5 - 2,9	0,005
16	3,0 - 5,9	0,005
25	6,0 - 9,9	0,005
40	10,0 - 17,9	0,008
50	18,0 - 26,9	0,008
60	27,0 - 34,0	0,008

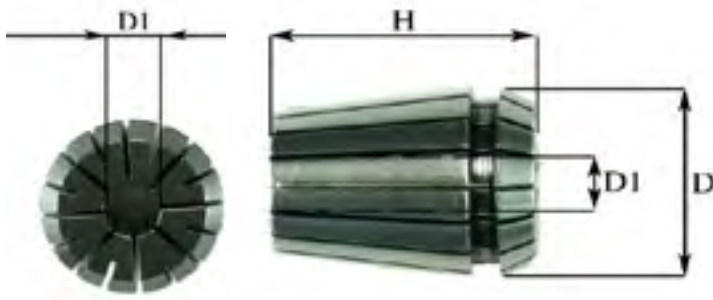

Pinze ER ultra precise High precision ER collets

	D	H	Articolo article	D1 - capacità D1 - clamping range	Note
ER 16 HP	16	27,5	ER16UP/D01	1-0,5	
			ER16UP/D02	2-1	
			ER16UP/D03	3-2	
			ER16UP/D04	4-3	
			ER16UP/D05	5-4	
			ER16UP/D06	6-5	
			ER16UP/D07	7-6	
			ER16UP/D08	8-7	
			ER16UP/D09	9-8	
			ER16UP/D10	10-9	
ER 20 HP	20	31,5	ER20UP/D01	1-0,5	
			ER20UP/D02	2-1	
			ER20UP/D03	3-2	
			ER20UP/D04	4-3	
			ER20UP/D05	5-4	
			ER20UP/D06	6-5	
			ER20UP/D07	7-6	
			ER20UP/D08	8-7	
			ER20UP/D09	9-8	
			ER20UP/D10	10-9	
			ER20UP/D11	11-10	
			ER20UP/D12	12-11	
			ER20UP/D13	13-12	
ER 25 HP	25	34	ER25UP/D01	1-0,5	
			ER25UP/D02	2-1	
			ER25UP/D03	3-2	
			ER25UP/D04	4-3	
			ER25UP/D05	5-4	
			ER25UP/D06	6-5	
			ER25UP/D07	7-6	
			ER25UP/D08	8-7	
			ER25UP/D09	9-8	
			ER25UP/D10	10-9	
			ER25UP/D11	11-10	
			ER25UP/D12	12-11	
			ER25UP/D13	13-12	
			ER25UP/D14	14-13	
			ER25UP/D15	15-14	
			ER25UP/D16	16-15	



DIN 6499 / B

Pinze ER ultra precise Hight precision ER collets

	D	H	Articolo article	D1 - capacità D1 - clamping range	Note
ER 32 HP	32	40	ER32UP/D02	2-1,5	
			ER32UP/D03	3-2	
			ER32UP/D04	4-3	
			ER32UP/D05	5-4	
			ER32UP/D06	6-5	
			ER32UP/D07	7-6	
			ER32UP/D08	8-7	
			ER32UP/D09	9-8	
			ER32UP/D10	10-9	
			ER32UP/D11	11-10	
			ER32UP/D12	12-11	
			ER32UP/D13	13-12	
			ER32UP/D14	14-13	
			ER32UP/D15	15-14	
			ER32UP/D16	16-15	
			ER32UP/D17	17-16	
			ER32UP/D18	18-17	
			ER32UP/D19	19-18	
			ER32UP/D20	20-19	
			ER 40 HP	40	46
ER40UP/D04	4-3				
ER40UP/D05	5-4				
ER40UP/D06	6-5				
ER40UP/D07	7-6				
ER40UP/D08	8-7				
ER40UP/D09	9-8				
ER40UP/D10	10-9				
ER40UP/D11	11-10				
ER40UP/D12	12-11				
ER40UP/D13	13-12				
ER40UP/D14	14-13				
ER40UP/D15	15-14				
ER40UP/D16	16-15				
ER40UP/D17	17-16				
ER40UP/D18	18-17				
ER40UP/D19	19-18				
ER40UP/D20	20-19				
ER40UP/D21	21-20				
ER40UP/D22	22-21				
ER40UP/D23	23-22				
ER40UP/D24	24-23				
ER40UP/D25	25-24				
ER40UP/D26	26-25				
ER40UP/D27	27-26				
ER40UP/D28	28-27				
ER40UP/D29	29-28				
ER40UP/D30	30-29				



Serie pinze ER ultra precise in valigetta *High precision ER collet set on plastic box*

Articolo <i>article</i>	Diametri <i>diameters</i>	Nr. Pz. Tot.	Note
ER16UP/1-10	1-2-3-4-5-6-7-8-9-10	10	
ER20UP/1-13	1-2-3-4-5-6-7-8-9-10-11-12-13	13	
ER25UP/2-16	2-3-4-5-6-7-8-9-10-11-12-13-14-15-16	15	
ER32UP/3-20	3-4-5-6-7-8-9-10-11-12-13 - 14-15-16-17-18-19-20	18	
ER32UP/2-22	2-3-4-5-6-7-8-9-10-11-12 -13-14-15-16 17-18-19-20-22	20	
ER40UP/3-30	3-4-5-6-7-8-9-10-11-12-13-14-15-16-17-18-19-20-21 22-23-24-25-26-27-28-29-30	28	



Su richiesta serie in valigetta con stesso numero di pinze ma con diametri a scelta
On request is possible to make customized set with different diameters but with the same number of collets

DIN 6388

Pinze EOC EOC collet

Conicità / taper 2°

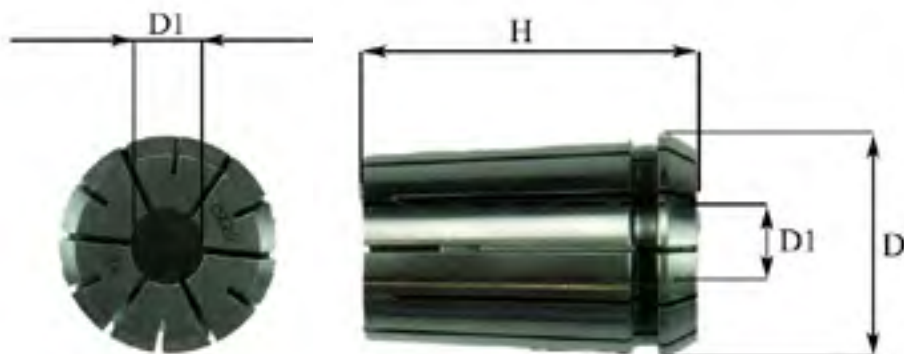

	D	H	Articolo article	D1 - Capacità D1 - Clamping range	Note
EOC25	35	52	EOC25/D02	2-1,5	
			EOC25/D03	3-2,5	
			EOC25/D04	4-3,5	
			EOC25/D05	5-4,5	
			EOC25/D06	6-5,5	
			EOC25/D07	7-6,5	
			EOC25/D08	8-7,5	
			EOC25/D09	9-8,5	
			EOC25/D10	10-9,5	
			EOC25/D11	11-10,5	
			EOC25/D12	12-11,5	
			EOC25/D13	13-12,5	
			EOC25/D14	14-13,5	
			EOC25/D15	15-14,5	
			EOC25/D16	16-15,5	
			EOC25/D17	17-16,5	
			EOC25/D18	18-17,5	
			EOC25/D19	19-18,5	
			EOC25/D20	20-19,5	
			EOC25/D21	21-20,5	
			EOC25/D22	22-21,5	
			EOC25/D23	23-22,5	
			EOC25/D24	24-23,5	
			EOC25/D25	25-24,5	
			INCH SIZE		
EOC25/D1/4	1/4"				
EOC25/D3/4	3/4"				

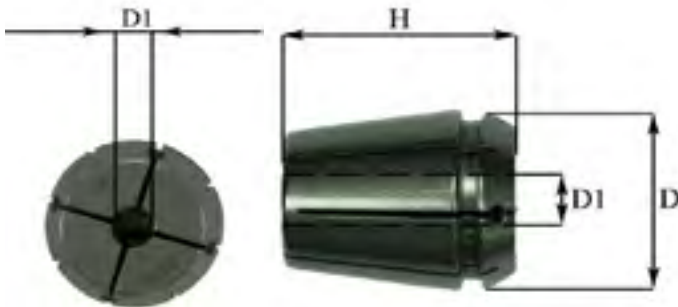

Pinze ER a tenuta con gommino

ER rubber sealed collets

Concentricità / concentricity 0,008 - 0,010

Pressione massima / max pressure: 60 Bar

Valori riferiti al diametro nominale delle pinze.

L'utensile deve essere bloccato per tutta la lunghezza utile di presa della pinza.

The tolerances are valid only for nominal diameter of the collet.

The chucking length of cutting tool shank is longer than the collet's bore length.

	D	H	Articolo article	D1 - capacità D1 - clamping range	Note			
ERT16	16	27,5	ERT16/D03	3-2,5				
			ERT16/D04	4-3,5				
			ERT16/D05	5-4,5				
			ERT16/D06	6-5,5				
			ERT16/D07	7-6,5				
			ERT16/D08	8-7,5				
			ERT16/D09	9-8,5				
			ERT16/D10	10-9,5				
			ERT20	20	31,5	ERT20/D03	3-2,5	
						ERT20/D04	4-3,5	
ERT20/D05	5-4,5							
ERT20/D06	6-5,5							
ERT20/D07	7-6,5							
ERT20/D08	8-7,5							
ERT20/D09	9-8,5							
ERT20/D10	10-9,5							
ERT20/D11	11-10,5							
ERT20/D12	12-11,5	>>						
ERT20/D13	13-12,5							

	D	H	Articolo article	D1 - Capacità D1 - Clamping range	Note
ERT25	25	34	ERT25/D03	3-2,5	
			ERT25/D04	4-3,5	
			ERT25/D05	5-4,5	
			ERT25/D06	6-5,5	
			ERT25/D07	7-6,5	
			ERT25/D08	8-7,5	
			ERT25/D09	9-8,5	
			ERT25/D10	10-9,5	
			ERT25/D11	11-10,5	
			ERT25/D12	12-11,5	
			ERT25/D13	13-12,5	
			ERT25/D14	14-13,5	
			ERT25/D15	15-14,5	
			ERT25/D16	16-15,5	
ERT32	32	40	ERT32/D03	3-2,5	
			ERT32/D04	4-3,5	
			ERT32/D05	5-4,5	
			ERT32/D06	6-5,5	
			ERT32/D07	7-6,5	
			ERT32/D08	8-7,5	
			ERT32/D09	9-8,5	
			ERT32/D10	10-9,5	
			ERT32/D11	11-10,5	
			ERT32/D12	12-11,5	
			ERT32/D13	13-12,5	
			ERT32/D14	14-13,5	
			ERT32/D15	15-14,5	
			ERT32/D16	16-15,5	
ERT32/D17	17-16,5				
ERT32/D18	18-17,5				
ERT32/D19	19-18,5				
ERT32/D20	20-19,5				
ERT40	40	46	ERT40/D04	4-3,5	
			ERT40/D05	5-4,5	
			ERT40/D06	6-5,5	
			ERT40/D07	7-6,5	
			ERT40/D08	8-7,5	
			ERT40/D09	9-8,5	
			ERT40/D10	10-9,5	
			ERT40/D11	11-10,5	
			ERT40/D12	12-11,5	
			ERT40/D13	13-12,5	
			ERT40/D14	14-13,5	
			ERT40/D15	15-14,5	
			ERT40/D16	16-15,5	
			ERT40/D17	17-16,5	
			ERT40/D18	18-17,5	
			ERT40/D19	19-18,5	
			ERT40/D20	20-19,5	
			ERT40/D21	21-20,5	
ERT40/D22	22-21,5				
ERT40/D23	23-22,5				
ERT40/D24	24-23,5				
ERT40/D25	25-24,5				
ERT40/D26	26-25,5				



Serie pinze ER a tenuta con gommino

ER rubber sealed collets set on plastic box

Articolo <i>article</i>	Diametri <i>diameters</i>	Nr. Pz. Tot.	Note
ERT16/3-10	3-4-5-6-7-8-9-10	8	
ERT20/3-13	3-4-5-6-7-8-9-10-11-12-13	11	
ERT25/3-16	3-4-5-6-7-8-9-10-11-12-13-14-15-16	14	
ERT32/3-20	3-4-5-6-7-8-9-10-11-12-13-14-15-16-17-18-19-20	18	
ERT40/4-26	4-5-6-7-8-9-10-11-12-13-14-15-16-17-18-19-20-21-22 23-24-25-26	23	



Su richiesta serie in valigetta con stesso numero di pinze ma con diametri a scelta
On request is possible to make customized set with different diameters but with the same number of collets

DIN 6499 / A

Pinze a tenuta sealed collets

Pinze ER a tenuta con gommino con passaggio forzato lubrificante *ER rubber sealed collets with forced passage of coolant flow*

Ultra precise / high precision

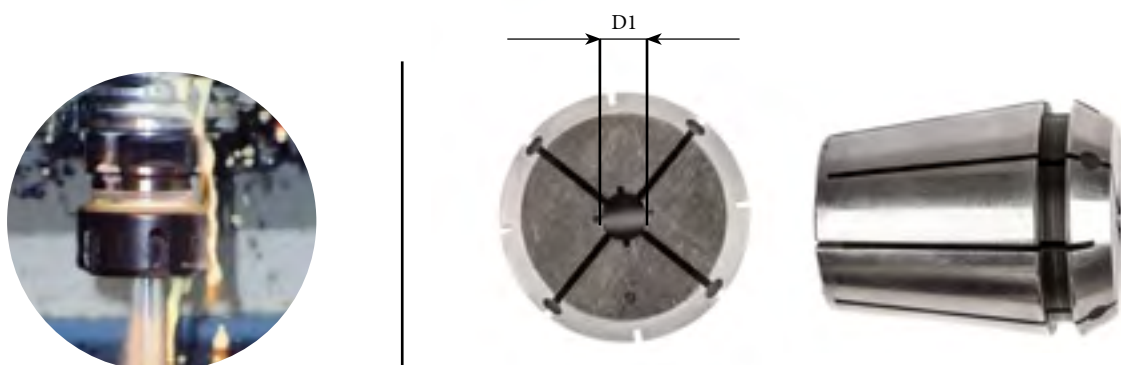

Concentricità / concentricity 0,005 - 0,008

Pressione massima / max pressure: 60 Bar

Valori riferiti al diametro nominale delle pinze. L'utensile deve essere bloccato per tutta la lunghezza utile di presa della pinza.

The tolerances are valid only for nominal diameter of the collet. The chucking length of cutting tool shank is longer than the collet's bore length.

Questa pinza consente di utilizzare normali ed economici utensili non forati in quanto convoglia il refrigerante su tutta la lunghezza dell'utensile.

These collet lets use the standard and economic tools without hole as it conveys the refrigerant along the entire length of the tool.



Pinze ER a tenuta con gommino con passaggio forzato lubrificante *ER rubber sealed collets with forced passage of coolant flow*

Ultra precise / high precision

	D	H	Articolo <i>article</i>	D1 - Capacità <i>D1 - Clamping range</i>	Note
ERTF16	16	27,5	ERTF16/D03	3-2,5	
			ERTF16/D04	4-3,5	
			ERTF16/D05	5-4,5	
			ERTF16/D06	6-5,5	
			ERTF16/D07	7-6,5	
			ERTF16/D08	8-7,5	
			ERTF16/D09	9-8,5	
			ERTF16/D10	10-9,5	
ERTF20	20	31,5	ERTF20/D03	3-2,5	
			ERTF20/D04	4-3,5	
			ERTF20/D05	5-4,5	
			ERTF20/D06	6-5,5	
			ERTF20/D07	7-6,5	
			ERTF20/D08	8-7,5	
			ERTF20/D09	9-8,5	
			ERTF20/D10	10-9,5	
			ERTF20/D11	11-10,5	
			ERTF20/D12	12-11,5	
ERTF25	25	34	ERTF25/D03	3-2,5	
			ERTF25/D04	4-3,5	
			ERTF25/D05	5-4,5	
			ERTF25/D06	6-5,5	
			ERTF25/D07	7-6,5	
			ERTF25/D08	8-7,5	
			ERTF25/D09	9-8,5	
			ERTF25/D10	10-9,5	
			ERTF25/D11	11-10,5	
			ERTF25/D12	12-11,5	
			ERTF25/D13	13-12,5	
			ERTF25/D14	14-13,5	
			ERTF25/D15	15-14,5	
			ERTF25/D16	16-15,5	



DIN 6499 / A

Pinze ER a tenuta con gommino con passaggio forzato lubrificante
ER rubber sealed collets with forced passage of coolant flow

	D	H	Articolo <i>article</i>	D1 - Capacità <i>D1 - Clamping range</i>	Note			
ERTF32	32	40	ERTF32/D03	3-2,5				
			ERTF32/D04	4-3,5				
			ERTF32/D05	5-4,5				
			ERTF32/D06	6-5,5				
			ERTF32/D07	7-6,5				
			ERTF32/D08	8-7,5				
			ERTF32/D09	9-8,5				
			ERTF32/D10	10-9,5				
			ERTF32/D11	11-10,5				
			ERTF32/D12	12-11,5				
			ERTF32/D13	13-12,5				
			ERTF32/D14	14-13,5				
			ERTF32/D15	15-14,5				
			ERTF32/D16	16-15,5				
			ERTF32/D17	17-16,5				
			ERTF32/D18	18-17,5				
			ERTF32/D19	19-18,5				
			ERTF32/D20	20-19,5				
			ERTF40	40	46	ERTF40/D04	4-3,5	
						ERTF40/D05	5-4,5	
ERTF40/D06	6-5,5							
ERTF40/D07	7-6,5							
ERTF40/D08	8-7,5							
ERTF40/D09	9-8,5							
ERTF40/D10	10-9,5							
ERTF40/D11	11-10,5							
ERTF40/D12	12-11,5							
ERTF40/D13	13-12,5							
ERTF40/D14	14-13,5							
ERTF40/D15	15-14,5							
ERTF40/D16	16-15,5							
ERTF40/D17	17-16,5							
ERTF40/D18	18-17,5							
ERTF40/D19	19-18,5							
ERTF40/D20	20-19,5							
ERTF40/D21	21-20,5							
ERTF40/D22	22-21,5							
ERTF40/D23	23-22,5							
ERTF40/D24	24-23,5							
ERTF40/D25	25-24,5							
ERTF40/D26	26-25,5							



**Serie pinze ER a tenuta
con passaggio forzato
lubrificante**
*ER rubber sealed collets
with forced passage of
coolant flow set on
plastic box*

Articolo <i>article</i>	Diametri <i>diameters</i>	Nr. Pz. Tot.	Note
ERTF16/3-10	3-4-5-6-7-8-9-10	8	
ERTF20/3-13	3-4-5-6-7-8-9-10-11-12-13	11	
ERTF25/3-16	3-4-5-6-7-8-9-10-11-12-13-14-15-16	14	
ERTF32/3-20	3-4-5-6-7-8-9-10-11-12-13-14-15-16-17-18-19-20	18	
ERTF40/4-26	4-5-6-7-8-9-10-11-12-13-14-15-16-17-18-19-20-21-22 23-24-25-26	23	

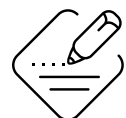

**Su richiesta serie in valigetta con stesso numero
di pinze ma con diametri a scelta**

*On request is possible to make customized set with different diameters but
with the same number of collets*

DIN 6499

Pinze a tenuta sealed collets

Pinze ER a tenuta meccanica ER mechanical sealed collets

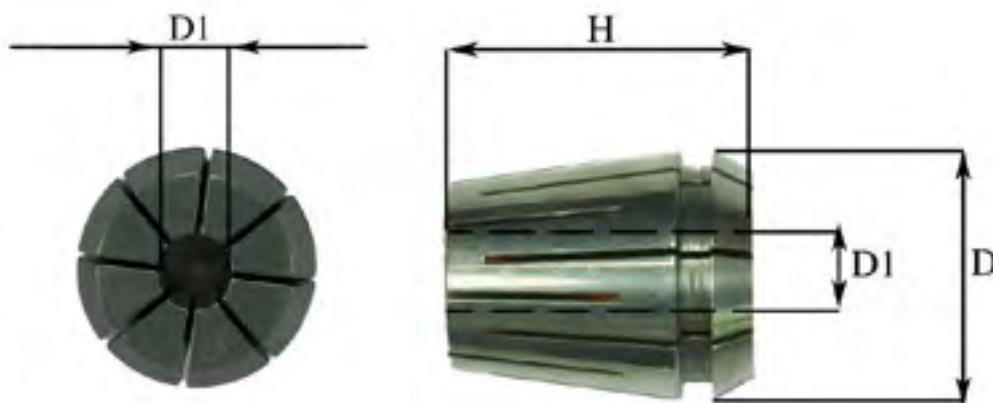

Concentricità / concentricity 0,008 - 0,010

Pressione massima / max pressure: 120 Bar

Conicità / taper 8°

Valori riferiti al diametro nominale delle pinze.

L'utensile deve essere bloccato per tutta la lunghezza utile di presa della pinza.

The tolerances are valid only for nominal diameter of the collet.

The chucking length of cutting tool shank is longer than the collet's bore length.

Il refrigerante viene canalizzato all'interno dell'utensile per la conformazione dei tagli che non ne consente il passaggio.

The refrigerant channeling into the internal of tool for the conformation of the cuts which does not allow its passage.



Pinze ER a tenuta meccanica ER mechanical sealed collets

<i>ERTS32</i>	D	H	Articolo article	D1 - Capacità D1 - Clamping range	<i>Note</i>			
ERTS16	16	27,5	ERTS16/D03	3-2,5				
			ERTS16/D04	4-3,5				
			ERTS16/D05	5-4,5				
			ERTS16/D06	6-5,5				
			ERTS16/D07	7-6,5				
			ERTS16/D08	8-7,5				
			ERTS16/D09	9-8,5				
			ERTS16/D10	10-9,5				
			ERTS20	20	31,5	ERTS20/D03	3-2,5	
						ERTS20/D04	4-3,5	
ERTS20/D05	5-4,5							
ERTS20/D06	6-5,5							
ERTS20/D07	7-6,5							
ERTS20/D08	8-7,5							
ERTS20/D09	9-8,5							
ERTS20/D10	10-9,5							
ERTS20/D11	11-10,5							
ERTS20/D12	12-11,5	>>						
ERTS20/D13	13-12,5							

DIN 6499

Pinze ER a tenuta meccanica ER mechanical sealed collets

	D	H	Articolo article	D1 - Capacità D1 - Clamping range	Note			
ERTS25	25	34	ERTS25/D03	3-2,5				
			ERTS25/D04	4-3,5				
			ERTS25/D05	5-4,5				
			ERTS25/D06	6-5,5				
			ERTS25/D07	7-6,5				
			ERTS25/D08	8-7,5				
			ERTS25/D09	9-8,5				
			ERTS25/D10	10-9,5				
			ERTS25/D11	11-10,5				
			ERTS25/D12	12-11,5				
			ERTS25/D13	13-12,5				
			ERTS25/D14	14-13,5				
			ERTS25/D15	15-14,5				
			ERTS25/D16	16-15,5				
			ERTS32	32	40	ERTS32/D03	3-2,5	
						ERTS32/D04	4-3,5	
ERTS32/D05	5-4,5							
ERTS32/D06	6-5,5							
ERTS32/D07	7-6,5							
ERTS32/D08	8-7,5							
ERTS32/D09	9-8,5							
ERTS32/D10	10-9,5							
ERTS32/D11	11-10,5							
ERTS32/D12	12-11,5							
ERTS32/D13	13-12,5							
ERTS32/D14	14-13,5							
ERTS32/D15	15-14,5							
ERTS32/D16	16-15,5							
ERTS32/D17	17-16,5							
ERTS32/D18	18-17,5							
ERTS32/D19	19-18,5							
ERTS32/D20	20-19,5							

DIN 6499

Pinze a tenuta sealed collets



Serie pinze ER a tenuta meccanica

ER mechanical sealed collets set on plastic box

Articolo <i>article</i>	Diametri <i>diameters</i>	Nr. Pz. Tot.	Note
ERTS16/3-10	3-4-5-6-8-7-9-10	8	
ERTS20/3-13	3-4-5-6-7-8-9-10-11-12-13	11	
ERTS25/3-16	3-4-5-6-7-8-9-10-11-12-13-14-15-16	14	
ERTF32/3-20	4-5-6-7-8-9-10-11-12-13-14-15-16-17-18-19-20	17	



Su richiesta serie in valigetta con stesso numero di pinze ma con diametri a scelta

On request is possible to make customized set with different diameters but with the same number of collets

Pinze cilindriche cylindrical collets

Pinze cilindriche per mandrini forte serraggio Cylindrical collets for milling chucks

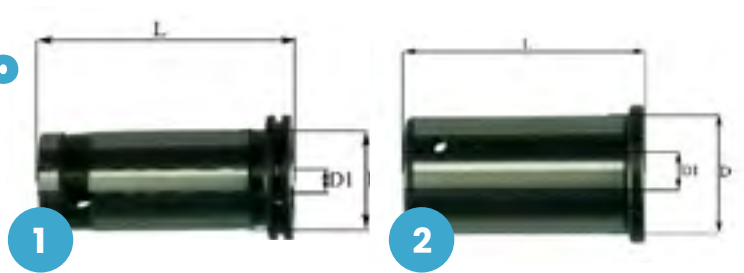

Articolo article	D	D1	L	Note
100/20	20	3-19	50	
100/25	25	3-22	58	
100/32	32	3-30	68	



Disponibili anche con misure decimali e in pollici
Available also with decimal and inch measurements

Pinze cilindriche a tenuta Cylindrical sealed collets

Articolo article	D	D1	L	Note
100/20T	20	3-16	50	
100/25T	25	3-20	58	
100/32T	32	4-26	68	

Pinze per mandrini idraulici Collets for hydraulic chucks

A tenuta meccanica del liquido del refrigerante
Mechanical sealed type for high pressure coolant flow

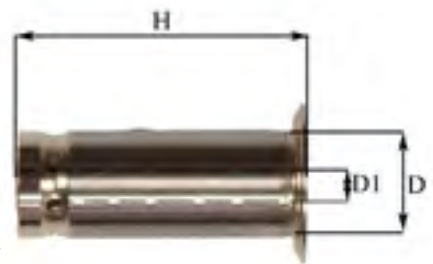

Articolo article	D	D1	L	Note
105/20	20	3-16	52,5	

Pinze Grifo grifo collets

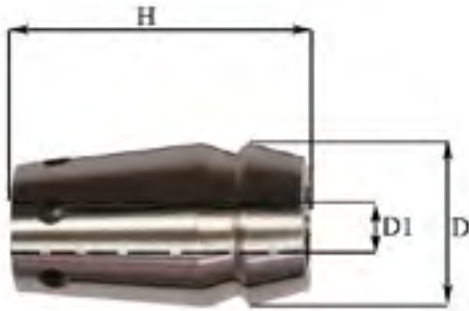

Pinze grifo Grifo collets

Conicità taper 5°

Articolo article	D	H	D1 - Capacità D1 - Capacity	Note
GRIFO/700	30	52	3-20	
GRIFO/800	44	65	6-32	

Disponibili anche con misure decimali
Available also with decimal measures



Articoli disponibili solo fino ad esaurimento scorte
Available only until run out of stock

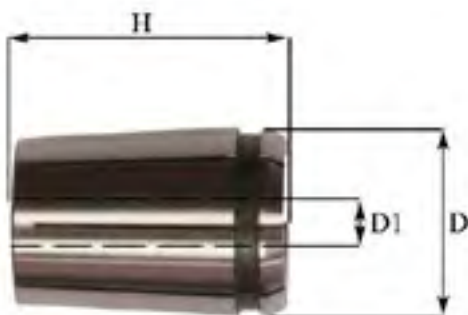

Pinze grifo per alta velocità Gifo high speed collets

Conicità taper 3°

Articolo article	D	H	D1 - Capacità D1 - Capacity	Note
GRIFO/290	32	45	3-25	

Disponibili anche con misure in pollici
Available also with inch sizes



Articoli disponibili solo fino ad esaurimento scorte
Available only until run out of stock

DIN 6499

Pinze ER con quadro per maschi

Er taper collets with internal square



DIN 371

DIN 374/376

Articolo <i>article</i>	Maschi DIN 371	Maschi DIN 374/376	D1 - Foro pinza <i>D1 - Collet hole</i>	D2 - Quadro maschio <i>D2 - Tap square</i>
ERM25/3,5	M 3	M 5	3,5	2,7
ERM25/4	M 3,5	-	4	3,0
ERM25/4,5	M 4	M 6	4,5	3,4
ERM25/5,5	-	5,5	5,5	4,5
ERM25/6	M 5 - M 6	M 8	6	4,9
ERM25/6,3	M 6	M 8	6,3	5,0
ERM25/7	M 7	M 9 - M 10	7	5,5
ERM25/8	M 8	M 11	8	6,2
ERM25/9	M 9	M 12	9	7,0
ERM25/10	M 10	-	10	8,0
ERM25/11	-	M 14	11	9,0
ERM25/11,2	-	M14	11,2	9,0
ERM25/12	-	M16	12	9,0
ERM25/16	-	-	16	12,0
ERM32/2,8	M 2 - M 2,5	M 4	2,8	2,1
ERM32/3,5	M 3	M 5	3,5	2,7
ERM32/4,5	M 4	M 6	4,5	3,4
ERM32/5,5	-	M 7	5,5	4,5
ERM32/6	M 5 - M 6	M 8	6	4,9
ERM32/7	M 7	M 9 - M 10	7	5,5
ERM32/8	M 8	M 11	8	6,2
ERM32/9	M 9	M 12	9	7,0
ERM32/10	M 10	-	10	8,0
ERM32/11	-	M 14	11	9,0
ERM32/12	-	M 16	12	9,0
ERM32/14	-	M 18	14	11,0
ERM32/16	-	M 20	16	12,0



**Serie in valigetta
pinze ER con quadro
per maschi**
*ER tap collets with
internal square set on
plastic box*

Articolo article	Diametri diameters	Nr. Pz. Tot.	Note
ERM25/4-16	4-4,5-5,5-6-7-8-9-10-11-12-16	11	
ERM32/3,5-16	3,5-4,5-5,5-6-7-8-9-10-11-12-14-16	12	



**Su richiesta serie in valigetta con stesso numero
di pinze ma con diametri a scelta**
*On request is possible to make customized set with different diameters but
with the same number of collets*

DIN 6499

Pinze ER di maschiatura con compensazione assiale incorporata

Tap collets with inside axial compensation

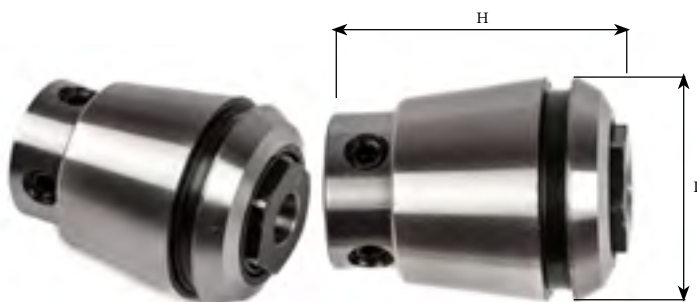

Articolo <i>article</i>	D1 - Diam. maschio <i>D1 - Tap diam.</i>	H	D	Note
ERMC32	4,5-5-6-7-8-9-10-11-12	43	32	

Serie in valigetta pinze ER di maschiatura con compensazione assiale incorporata

ER tap collets with inside axial compensation set on plastic box



Articolo <i>article</i>	Diametri <i>diameters</i>	Nr. Pz. Tot	Note
ERMC32/4,5-12	4,5-5-6-7-8-9-10-11-12	9	



Su richiesta serie in valigetta con stesso numero di pinze ma con diametri a scelta

On request is possible to make customized set with different diameters but with the same number of collets

Codoli Pull studs

A richiesta si costruiscono codoli speciali su disegni o campione
On request we manufacture special type of pull studs with drawing or sample



Assicurarsi che il tirante sia avvitato completamente sul mandrino per evitare la caduta del portautensili che può causare seri danni alla macchina e all'operatore.

Be sure to fully tighten the pull stud, for to avoid the serious injuries to the worker or damage to the machine.



Codoli speciali



DIN 69872 / A

Codoli Pull studs

Forato With hole

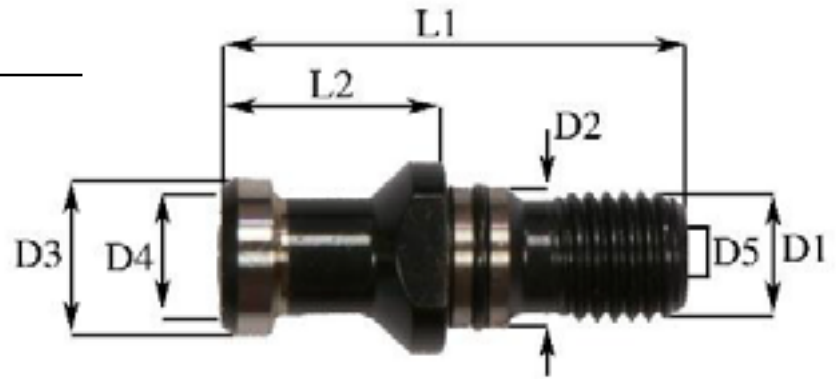

Articolo article	Attacco adapter	D1	D2	D3	D4	D5	L1	L2	Note
70/M12FDIN	ISO 30	M12	13	13	9	4	44	24	
70/M16FDIN	ISO 40	M16	17	19	14	7	54	26	
70/M24FDIN	ISO 50	M24	25	28	21	11,5	74	34	

DIN 69872 / B

Codoli Pull studs

Senza foro Without hole



Articolo article	Attacco adapter	D1	D2	D3	D4	L1	L2	Note
70/M12SFDIN	ISO 30	M12	13	13	9	44	24	
70/M16SFDIN	ISO 40	M16	17	19	14	54	26	
70/M24SFDIN	ISO 50	M24	25	28	21	74	34	



Disponibile anche tipo con sede balluff
Available also with balluff id hole

DIN 7388 / 2B

Codoli Pull studs

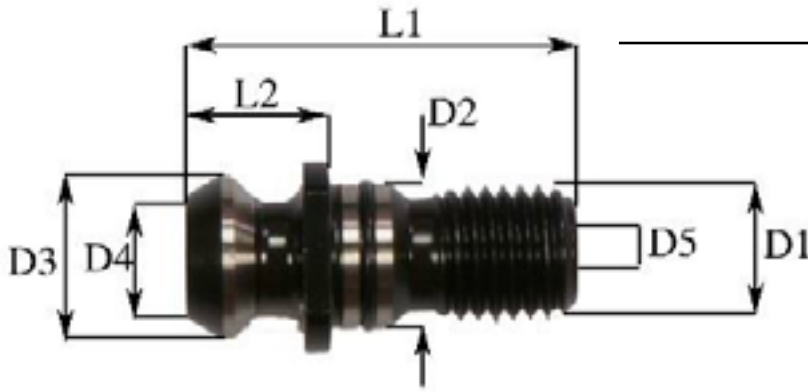

Forato
With hole

Articolo article	Attacco adapter	D1	D2	D3	D4	D5	L1	L2	Note
70/M16FISO	ISO 40 forato	M16	17	18,95	12,95	7,35	44,55	16,40	
70/M24FISO	ISO 50 forato	M24	25	29	23,70	11,5	65,50	25,60	

DIN 7388 / 2B

Codoli Pull studs

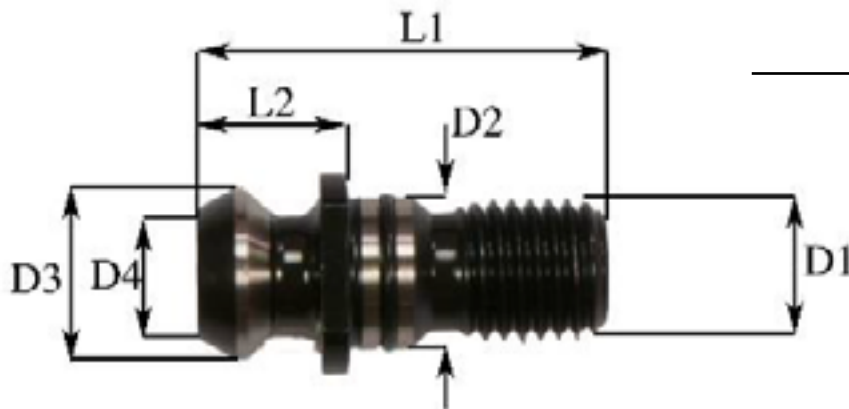

Senza foro
without hole

Articolo article	Attacco adapter	D1	D2	D3	D4	L1	L2	Note
70/M16SFISO	ISO 40	M16	17	18,95	12,95	44,55	16,40	
70/M24SFISO	ISO 5	M24	25	29	23,70	65,50	25,60	

MAS BT

Codoli Pull studs

Forato With hole

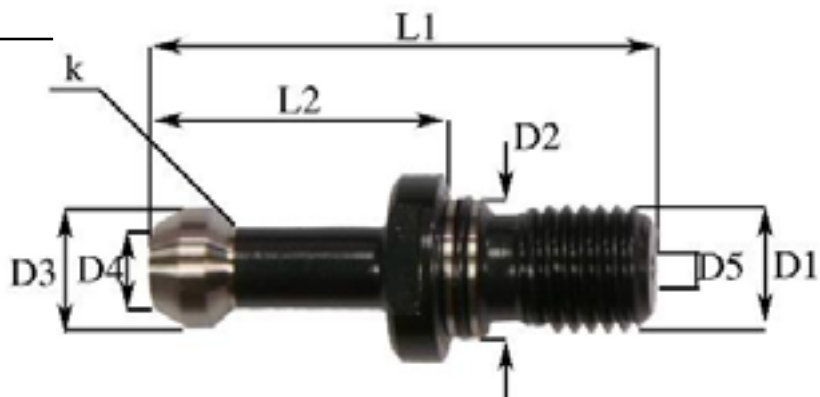

Articolo article	Attacco adapter	D1	D2	D3	D4	D5	K	L1	L2	Note
70/M12FBT45	BT 30	M12	12,5	11	7	3	45°	43	23	
70/M16FBT45	BT 40	M16	17	15	10	5	45°	60	35	
70/M16FBT60	BT 40	M16	17	15	10	5	60°	60	35	
70/M16FBT90	BT 40	M16	17	15	10	5	90°	60	35	
70/M24FBT45	BT 50	M24	25	23	17	6	45°	85	45	
70/M24FBT90	BT 50	M24	25	23	17	6	90°	85	45	

MAS BT

Codoli Pull studs

Senza foro without hole

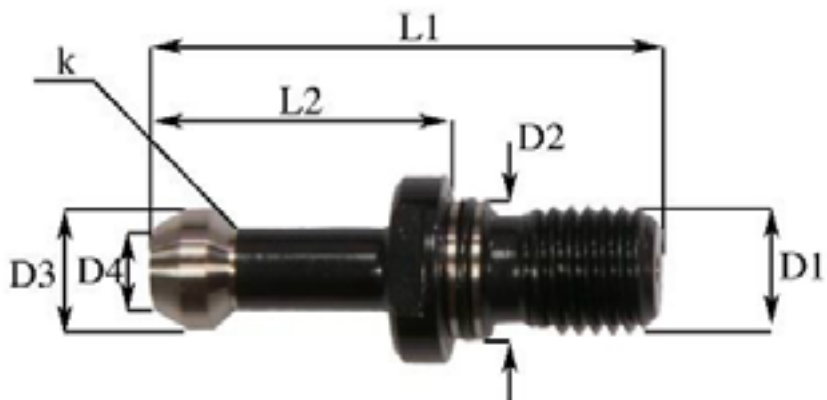

Articolo article	Attacco adapter	D1	D2	D3	D4	K	L1	L2	Note
70/M12SFBT45	BT 30	M12	12,5	11	7	45°	43	23	
70/M16SFBT45	BT 40	M16	17	15	10	45°	60	35	
70/M16SFBT60	BT 40	M16	17	15	10	60°	60	35	
70/M16SFBT90	BT 40	M16	17	15	10	90°	60	35	
70/M24SFBT45	BT 50	M24	25	23	17	45°	85	45	
70/M24SFBT90	BT 50	M24	25	23	17	90°	85	45	

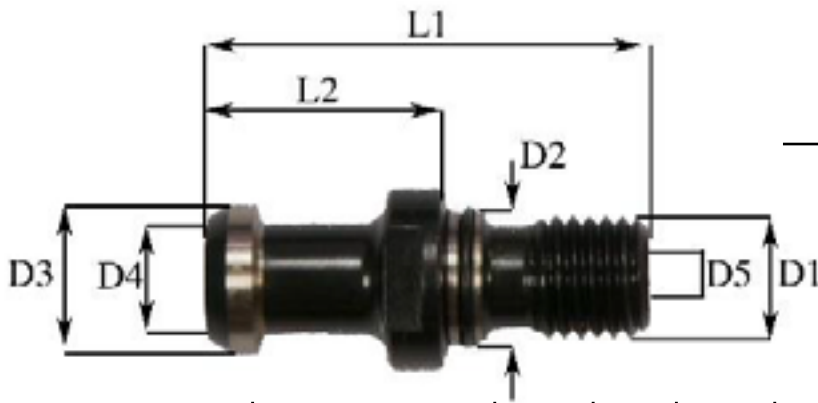

JIS B 6339

Codoli Pull studs

Forato
With hole

Articolo article	Attacco adapter	D1	D2	D3	D4	D5	L1	L2	Note
70/M16FJIS	ISO 40	M16	17	19	14	5,5	54	29	



JIS B 76339

Codoli Pull studs

Senza foro
without hole

Articolo article	Attacco adapter	D1	D2	D3	D4	L1	L2	Note
70/M16SFJIS	ISO 40	M16	17	19	14	54	29	

Tipo OTT OTT system

Codoli Pull studs

**Forato con
filetto interno**

With hole and inside threaded

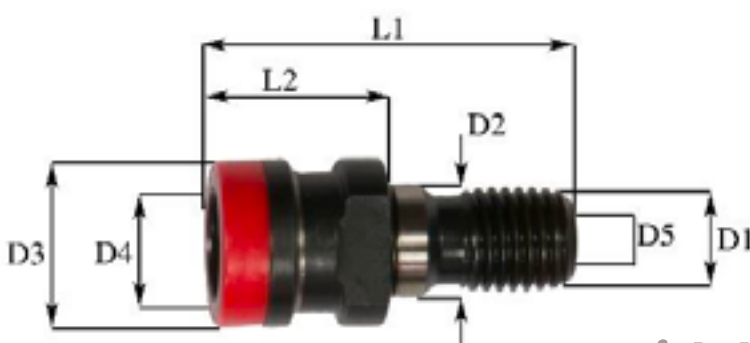

Articolo article	Attacco adapter	D1	D2	D3	D4	D5	L1	L2	Note
70/M16OTT	ISO40 DIN 2080	M16	17	25	21	7	53	25	
70/M24OTT	ISO50 DIN 2080	M24	25	39,3	24	10,5	65,4	26	

DIN 69872 / BT

Codoli Pull studs

Forato With hole

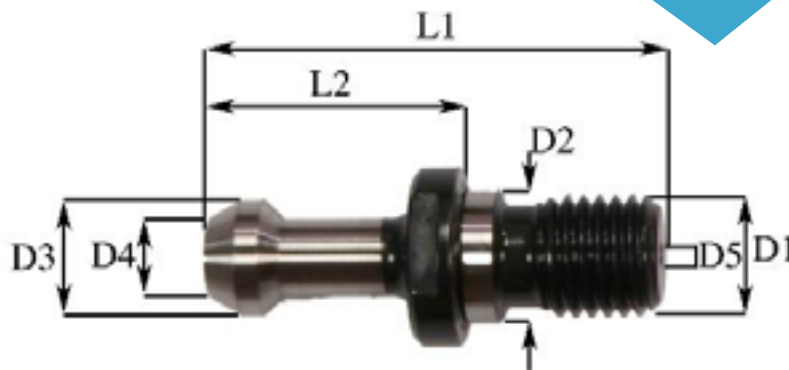

Articolo article	Attacco adapter	D1	D2	D3	D4	D5	L1	L2	Note
70/M16FDIN/BT	ISO 40	M16	17	19	14	5	57	32	90°

DIN 69872 / BT

Codoli Pull studs

Senza foro Without hole

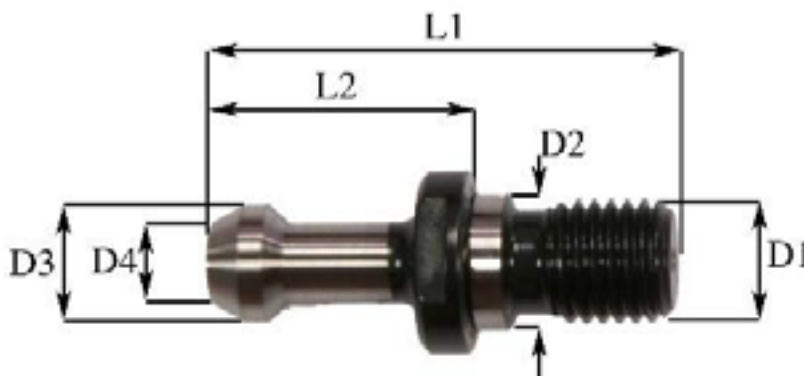

Articolo article	Attacco adapter	D1	D2	D3	D4	L1	L2	Note
70/M16SFDIN/BT	ISO 40	M16	17	19	14	57	32	90°

MAZAC

Codoli Pull studs

Forato With hole

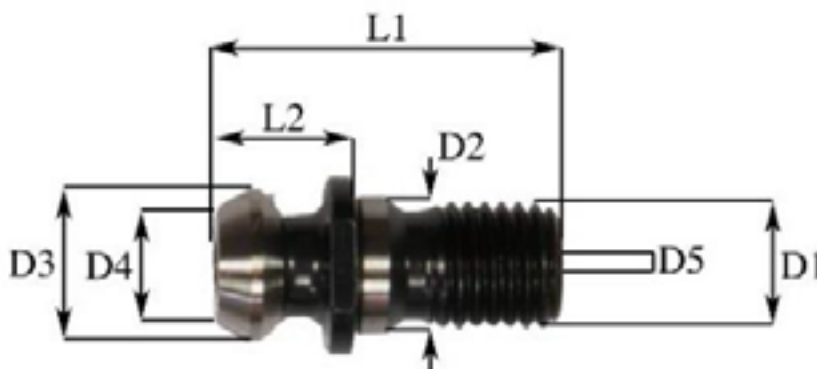

Articolo article	Attacco adapter	D1	D2	D3	D4	D5	L1	L2	Note
70/M16MAZ	ISO 40	M16	17	18,80	12,45	7	41,26	16,26	

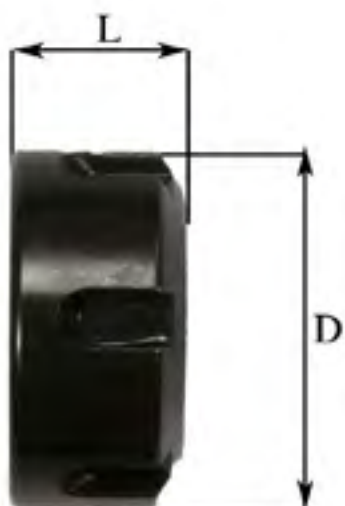

Ghiere per pinze ER con estrazione eccentrica della pinza

Nuts for ER collets with eccentric collet extractor

Articolo <i>article</i>	D	Filetto DX <i>right thread</i>	L	Pinza <i>collet</i>	Note
80/ER16 STANDARD	32	M 22 x 1,50	17	ER16	
80/ER20 STANDARD	35	M 25 x 1,50	18,5	ER20	
80/ER25 STANDARD	42	M 32 x 1,50	20	ER25	
80/ER32 STANDARD	50	M 40 x 1,50	22,5	ER32	
80/ER40 STANDARD	63	M 50 x 1,50	25,5	ER40	
80/ER16B BILANCIATA	32	M 22 x 1,50	17	ER16	RpM 24000
80/ER20B BILANCIATA	35	M 25 x 1,50	18,5	ER20	RpM 24000
80/ER25B BILANCIATA	42	M 32 x 1,50	20	ER25	RpM 24000
80/ER32B BILANCIATA	50	M 40 x 1,50	22,5	ER32	RpM 24000
80/ER40B BILANCIATA	63	M 50 x 1,50	25,5	ER40	RpM 24000

Ghiere nuts

Ghiere mini per pinze ER con estrazione eccentrica della pinza

Mini nuts for ER collets with eccentric collet extractor

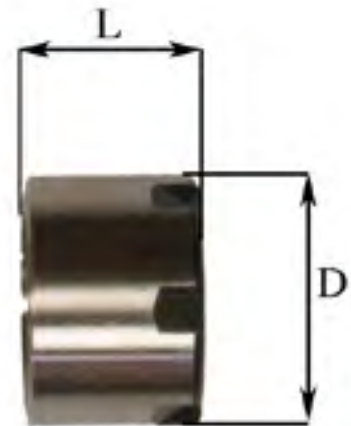

Articolo <i>article</i>	D	Filetto DX <i>right thread</i>	L	Pinza <i>collet</i>	Note
80/ER8M MINI	12	M 10 x 0,75	10,8	ER8	
80/ER11M MINI	16	M 13 x 0,75	12	ER11	
80/ER16M MINI	22	M 19 x 1,00	18	ER16	
80/ER20M MINI	28	M 24 x 1,00	19	ER20	
80/ER25M MINI	35	M 30 x 1,00	20	ER25	

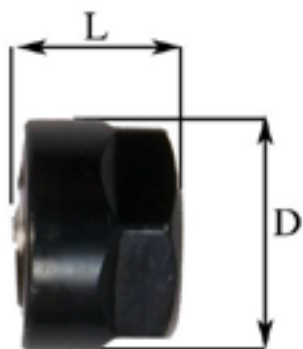

Ghiere ER esagonali eccentriche Hexagonal eccentric ER nuts

Articolo article	D	Filetto DX right thread	L	Pinza collet	Note
80/ER11E	19	M14 x 0,75	11,3	ER11	
80/ER16E	28	M22 x 1,5	17	ER16	
80/ER20E	34	M25 x 1,5	19	ER20	
80/ER25E	42	M32 x 1,5	20	ER25	

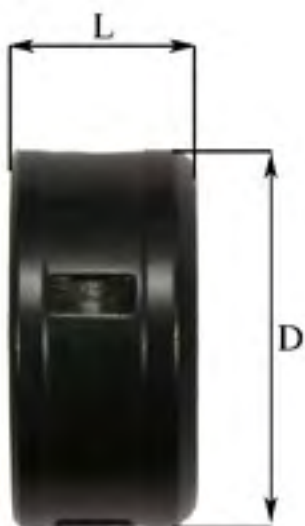

Ghiere per pinze ER con estrazione concentrica della pinza adatte per mandrini bilanciati Nuts for ER collets with concentric collet extractor for balanced chucks

Articolo article	D	Filetto DX right thread	L	Pinza collet	Note
80/ER25C	42	M 32 x 1,50	20	ER25	
80/ER32C	50	M 40 x 1,50	22,5	ER32	
80/ER40C	63	M 50 x 1,50	25,5	ER40	
80/290	50	M 40 x 1,50	24	GRIFO/290	

Chiavi per ghiera wrench for nuts

Chiavi per ghiera ER standard

Wrench for ER standard nuts



Articolo chiave <i>wrench article</i>	Tipo ghiera <i>nut type</i>	Note
90/ER16	ER16 STANDARD	
90/ER20	ER20 STANDARD	
90/ER25	ER25 STANDARD	
90/ER32	ER32 STANDARD	
90/ER40	ER40 STANDARD	

Chiavi ER salvaghiera a torsione con taratura fissa

*Save-nut ER torque wrench
with a single fixed snap calibration*



Articolo chiave <i>wrench article</i>	Tipo ghiera <i>nut type</i>	Note
90/ER25TW	ER25	
90/ER32TW	ER32	
90/ER40TW	ER40	

Chiavi per ghiera wrench for nuts

Chiavi per ghiera ER mini Wrench for mini ER nuts



Articolo chiave wrench article	Tipo ghiera nut type	Note
90/ER8M	ER8 MINI	
90/ER11M	ER11 MINI	
90/ER16M	ER16 MINI	
90/ER20M	ER20 MINI	
90/ER25M	ER25 MINI	

Chiavi per ghiera ER esagonali Wrench with hexagonal ER nuts



Articolo chiave wrench article	Tipo ghiera nut type	Note
90/ER11E	ER11 ESAG.	
90/ER16E	ER16 ESAG.	
90/ER20E	ER20 ESAG.	
90/ER25E	ER25 ESAG.	

Chiavi per ghiera wrench for nuts

Chiavi per ghiera alta velocità e forte serraggio Wrench for high speed nuts and for milling chucks



Articolo chiave wrench article	Tipo ghiera/mandrino nut/chuck type	Note
90/ER32C	GHIERA/NUT art.80/ER32C	
90/20FS	MANDRINO/CHUCK DIAM.20	
90/32FS	MANDRINO/CHUCK DIAM.32	

Chiavi per viti a croce Wrench for cross screw



Articolo chiave wrench article	Tipo vite screw type	Note
80/PFR/16	M8	
80/PFR/22	M10	
80/PFR/27	M12	
80/PFR/32	M16	
80/PFR/40	M20	

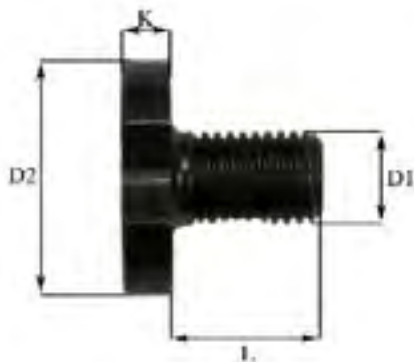

Viti a croce cross screw

Per mandrini portafrese For mill holder spindles

Articolo article	D1	D2	L	K	Note
120/PFR/M8	M8	20	16	6	
120/PFR/M10	M10	28	18	7	
120/PFR/M12	M12	35	22	8	
120/PFR/M16	M16	41	26	9	
120/PFR/M20	M20	51	30	10	
120/PFR/M24	M24	62	35	12	

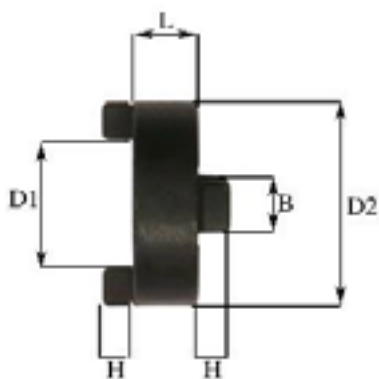

Anelli di trascinamento clutch drive rings

Per mandrini portafrese For mill holder spindles

Articolo article	L	H	D1	D2	Note
120/16	10	5	16	32	
120/22	12	5,6	22	40	
120/27	12	6,3	27	48	
120/32	14	7	32	58	
120/40	14	8	40	70	

Chiavette drive keys

Per mandrini portafrese For mill holder spindles

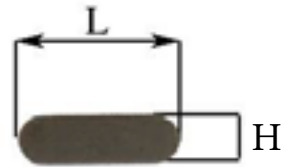

Articolo article	H	L	Note
121/16	4	20	
121/22	6	25	
121/27	7	25	
121/32	8	28	
121/40	10	32	

Tasselli per portafrese fissi e prolunghe

dowels for face mill holders and extensions

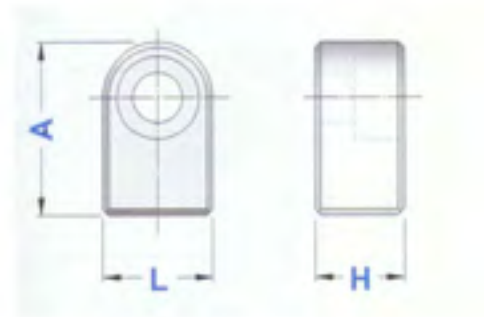

Articolo article	Diam.	H	L	A	Note
122/16	16	7	8	13	
122/22	22	8	10	15,6	
122/27	27	9	12	18,3	
122/32	32	11	14	21	
122/40	40	13	16	24	

Grani per portafrese weldon

weldon locking screws

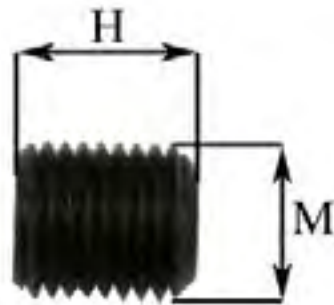

Articolo <i>article</i>	M	H	Note
WE/06	6	10	
WE/08	8	10	
WE/10	10	12	
WE/12	12	16	
WE/14	12	16	
WE/16	14	16	
WE/18	14	16	
WE/20	16	16	
WE/25	18	20	
WE/32	20	20	
WE/40	20	20	

Prolunghe per P / Frese fissi

face mill extensions

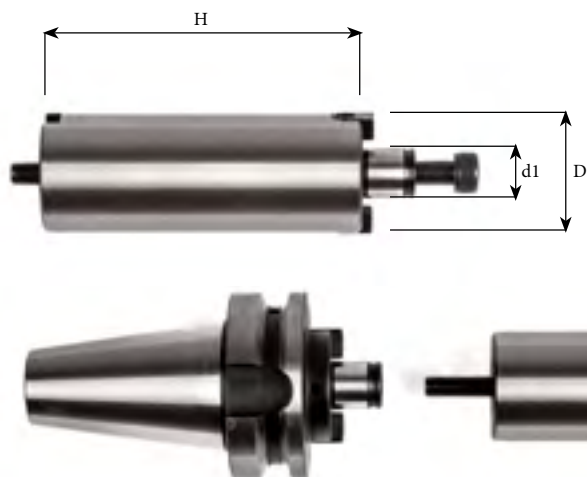

Articolo article	D1	H	D	Note
110/16/030	16	30	38	
110/16/100	16	100	38	
110/22/030	22	30	48	
110/22/100	22	100	48	
110/27/035	27	35	58	
110/27/100	27	100	58	
110/32/040	32	40	64	
110/32/100	32	100	64	
110/40/050	40	45	80	
110/40/120	40	120	80	



Fornite complete di viti
Supplied complete with screws

Smontacono orientabile 360° Orientable assembly support



Articolo article	Attacchi adapters	Foto photo	Note
152/OR50	BT30 – ISO30 DIN69871- ISO30 DIN2080 – HSK50 – CAPTO C5	1	
152/OR63	BT40 – ISO40 DIN69871 – HSK63A	2	
152/OR63SE	BT40 – ISO40 DIN69871 – HSK63A-B-C-D-E-F – CAPTO C6	1	

Smontacono fisso fixed assembly support



Articolo article	Attacchi adapters	Foto photo	Note
152/F50	BT30 – ISO30 DIN69871 – ISO30 DIN2080 – HSK50 – CAPTO C5	1	
152/F63	BT40 – ISO40 DIN69871 – HSK63A	2	
152/F63SE	BT40 – ISO40 DIN69871 – HSK63A-B-C-D-E-F – CAPTO C6	1	
152/F100	BT50 – HSK100A	2	
152/F97	ISO50 DIN69871 – ISO50 DIN2080	2	



ORDINI

Gli ordini sono intesi salvo ns. approvazione. Per le lavorazioni speciali su richiesta del Cliente non sono ammessi annullamenti degli ordini dopo i tre giorni lavorativi dalla conferma degli stessi.



TERMINI DI CONSEGNA

La consegna è intesa in giorni lavorativi decorrenti dalla data dell'ordine. Resta comunque indicativa salvo imprevisti di lavorazione.



SPEDIZIONI

La merce viaggia a rischio e pericolo del committente anche se spedita in porto franco. La merce si intende venduta franco ns. stabilimento e consegnata al momento dell'affidamento allo spedizioniere prescelto dal Cliente.



IMBALLO

E' compreso nel costo.



PREZZI E FATTURAZIONE

I prezzi indicati sono IVA esclusa. I prezzi riportati sul nostro listino sono suscettibili di variazioni senza necessità di preavviso da parte nostra. Non vi è importo minimo di fatturazione. Per le fatture di importo inferiore a € 120,00 non viene emessa ricevuta bancaria e si richiede pagamento con rimessa diretta al ricevimento della merce.



PAGAMENTI

Tutti i pagamenti devono essere effettuati presso la ns. sede. Non sono ammessi sconti o arrotondamenti se non conteggiati in fattura. In caso di ritardo nel pagamento decorreranno gli interessi commerciali nella misura del saggio ufficiale di sconto aumentato di tre punti, oltre alle spese bancarie sostenute.



GARANZIA E RESI

La merce da noi riconosciuta difettosa di produzione viene sostituita gratuitamente. Non si risponde di danni per uso improprio, manipolazioni, modifiche. I resi vanno effettuati in porto franco e sono accettati solo previo ns. autorizzazione. Non si accettano resi dopo 15 giorni dalla data di spedizione.



FORO COMPETENTE

In caso di contestazioni è competenza esclusiva del foro di Cremona.



ORDERS

The orders are subject to our approval. For the special machining on request of the Client, it is not admitted to annul the orders after 3 week days since the confirmation of them.



TERMS OF DELIVERY

The delivery is considered in week days and have effect from the date of the order. It remain however approximate excepted unexpected about machining.



DELIVERY

Goods are supplied ex-our warehouse, travel at the risk of the customer and it is intended delivered at the moment of the entrusting to the Forwarder that the Client have selected.



PACKING

It is included in the cost.



PRICES AND BILLING

The prices indicated are VAT excluded. The prices indicated in this price list may be subject to variations without our prior notifications. There is not a minimum cost of billing. For the invoices with a cost greater than € 120,00 we required payment in cash to delivery.



PAYMENTS

All payments shall be made to our offices. The discounts and the rounded-off figures will not be accepted if they are not charged in the invoice. In the event of a delayed payment, commercial interests shall be applied with reference to the official rate of discount, increased of 3 points, and the banking costs supported by us.



GUARANTEE

The goods which we consider defective shall be replaced free-of-charge. The guarantee does not take into consideration inappropriate use, abuse, misuse, neglect. The goods give back shall be made free port and are accepted only if is authorized by our Company. No return will be accepted after 15 days from the delivery.



COURT OF COMPETENT JURISDICTION

The court of Cremona (Italy) shall have exclusive jurisdiction.

Note notes



Le quote indicate sul presente catalogo sono indicative e possono subire lievi variazioni a ns. discrezione.
The size in this catalogue is indicative and can be varied.

Per evitare disguidi in fase di ordinazione indicare sempre il codice dell'articolo.
Please write the article code in your order to avoid technical misunderstanding.

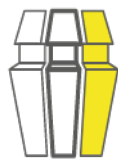

Brusa & C.
Tooling s.r.l

Attrezzature per macchine utensili

Via XXV Aprile, 23, Castelleone
Cremona | CAP 26012, Italia

+39 0374 350031

www.brusatooling.it | info@brusatooling.it

